

# SATELLITE POSITIONING REFERENCE STATION SUMMARY

STATION NO. : HKWS (FORMER NO. : \_\_\_\_\_)

ACCURACY CLASS : \_\_\_\_\_

TRIG. NAME : WONG SHEK SATELLITE POSITIONING REFERENCE STATION

LOCALITY : WONG SHEK

<b>HK 80 DATUM</b>	<p><b>HK 1980 GRID COORDINATES</b> : N = <u>832 774.156</u> m , E = <u>852 585.076</u> m , Ht = <u>66.107</u> m (1)</p> <p style="text-align: center;"><i>Note (1) : Height is above the HKPD and measured to the top of mark.</i></p> <p><b>LEVEL ACCURACY</b> : _____</p> <p><b>SCALE FACTOR</b> : + <u>3.1</u> ppm to measured distance to give Grid Distance</p> <p><b>GRID CONVERGENCE</b> : + <u>3' 32.1"</u> to Grid Bearings to give Azimuth</p>
<b>WGS 84 DATUM</b>	<p><b>GEOGRAPHICAL COORDINATES</b> : Lat <u>22° 26'3.41646"</u> N, Long <u>114° 20'7.35829"</u> E, Ht = <u>63.789</u>m (2)</p> <p style="text-align: center;"><i>Note (2) : Height is above the WGS 84 Ellipsoid and measured to the top of mark.</i></p> <p><b>GPS ACCURACY</b> : _____</p> <p><b>REFERENCE FRAME</b> : ITRF96</p> <p><b>UTM GRID COORDINATES</b> : <u>2 483 332</u> mN <u>225 730</u> mE</p> <p><b>UTM GRID REFERENCE</b> : <u>50Q KK 257 833</u></p>

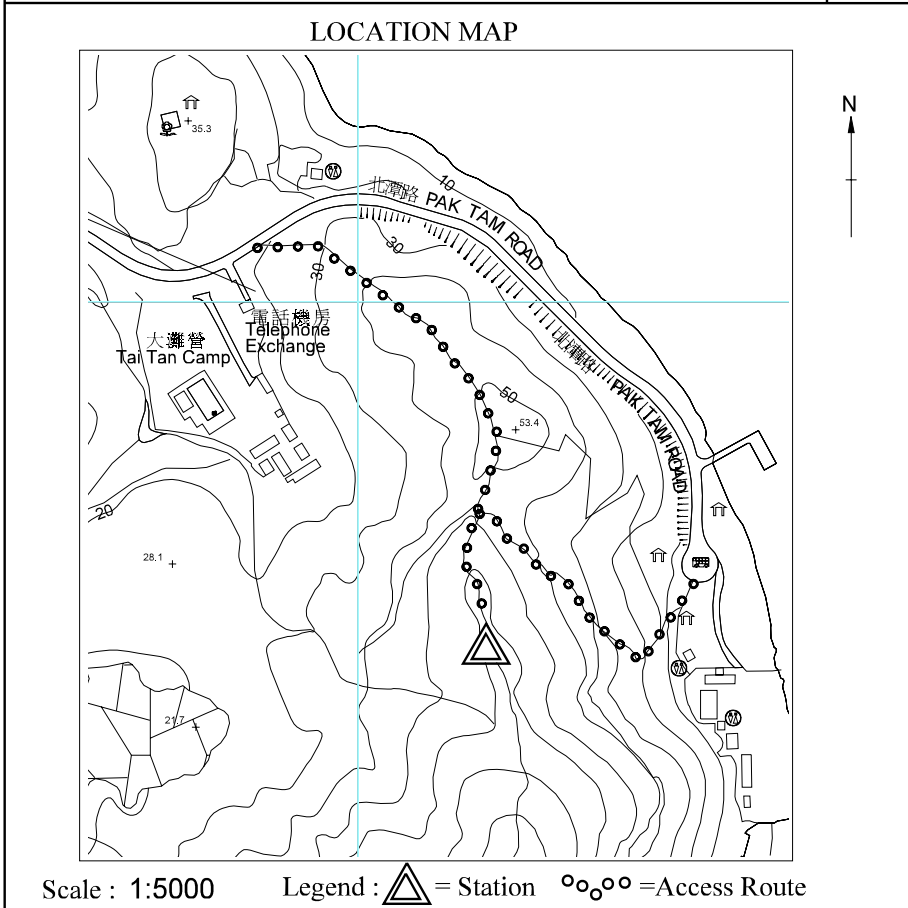
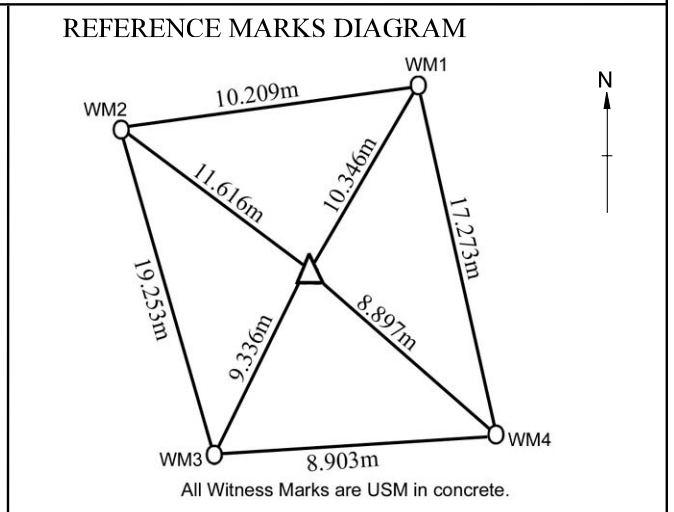
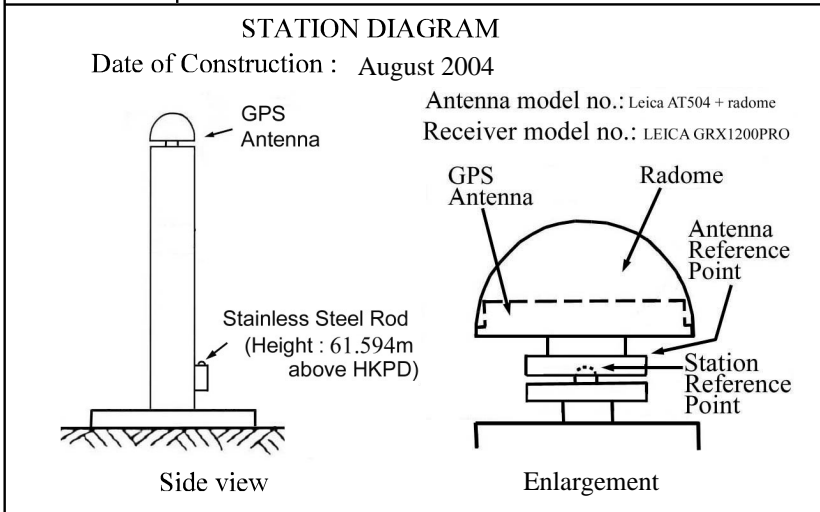

**GRID BEARINGS TO ADJACENT TRIGS.**

**LAST MAINTENANCE RECORD :**

Last visit on : **14/10/2004**

**REMARKS :**

- 1) The Station Reference Point (horizontal & vertical) is at the top of the nipple of the lower antenna mount.
- 2) The height from the Station Reference Point to the Antenna Reference Point (bottom of antenna) is 0.008m.
- 3) The HK 1980 grid coordinates of this station are transformed from GPS surveyed geodetic coordinates.