

TRIGONOMETRICAL STATION SUMMARY

STATION NO. : 134 (FORMER NO. :)

CLASS :

TRIG. NAME : CHAI WAN

LOCALITY : SHEUNG ON ST., CHAI WAN

HK 80 DATUM	HK 1980 GRID COORDINATES : N = <u>814 292.910</u> m , E = <u>843 164.177</u> m , Ht = <u>87.2</u> m (1) <i>Note (1) : Height is above the HKPD and measured to the top of mark.</i> LEVEL ACCURACY : SCALE FACTOR : + <u>0.5</u> ppm to measured distance to give Grid Distance GRID CONVERGENCE : <u>+ 1' 25.6"</u> to Grid Bearings to give Azimuth
WGS 84 DATUM	GEOGRAPHICAL COORDINATES : Lat _____ N, Long _____ E, Ht= _____ m (2) <i>Note (2) : Height is above the WGS 84 Ellipsoid and measured to the top of mark.</i> GPS ACCURACY : REFERENCE FRAME : UTM GRID COORDINATES : <u>2 465 021</u> mN <u>215 959</u> mE UTM GRID REFERENCE : <u>50Q KK 160 650</u>

STATION DIAGRAM

Date of Construction : 04/1989

Type of Mark :

USM on water tank at
Federal Centre

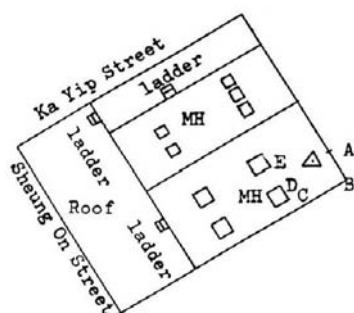

Plan view

REFERENCE MARKS DIAGRAM

- 134 - A 1.070 point on building line
- B 1.972 inner corner of building
- C 0.812 corner of MH
- D 0.556 corner of MH
- E 2.803 corner of MH



LOCATION MAP

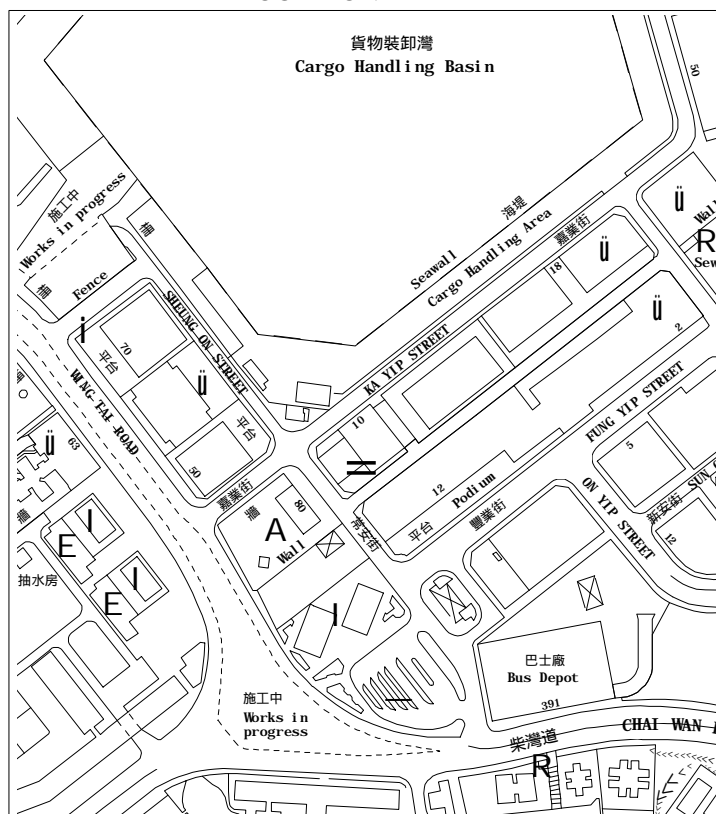

Scale : 1:5000

Legend : = Station = Access Route

GRID BEARINGS TO ADJACENT TRIGS.

128	0° 05' 42"
604	67° 18' 48"
603	76° 16' 19"
201	167° 37' 25"

LAST MAINTENANCE RECORD :

Last visit on : 10/2001

REMARKS :

Contact watchman for key, lift up to 24th floor, walk up steps to roof top. Climb iron ladder to top of water tank.