

# TRIGONOMETRICAL STATION SUMMARY

STATION NO. : **224** (FORMER NO. : \_\_\_\_\_)

SURVEY SHEET NO. : **9-SW-19D**

TRIG. NAME : **LUK WU**

LOCALITY : **CHEUNG SHAN, LANTAU**

<b>HK 80 DATUM</b>	HK 1980 GRID COORDINATES : N = <b>813 496.147</b> m, E = <b>805 644.341</b> m, Class : <b>H2</b> Ht = <b>450.1</b> m above HKPD and measured to the top of mark, Class : <b>V5</b> SCALE FACTOR : <b>+ 11.9</b> ppm to measured distance to give Grid Distance GRID CONVERGENCE : <b>- 06' 50.8"</b> to Grid Bearings to give Azimuth
------------------------	--

<b>WGS 84 DATUM</b>	GEOGRAPHICAL COORDINATES : Lat = <b>22° 15' 35.99100"</b> N, Long = <b>113° 52' 47.16707"</b> E, Class : <b>GH3</b> Ht = <b>446.121</b> m above Ellipsoid and measured to the top of mark, Class : <b>GV3</b> Reference Frame = <b>ITRF96</b> UTM GRID COORDINATES : <b>2 464 432</b> mN, <b>796 796</b> mE UTM GRID REFERENCE : <b>49Q GE 967 644</b>
-------------------------	--

STATION PHOTO



REFERENCE MARKS DIAGRAM

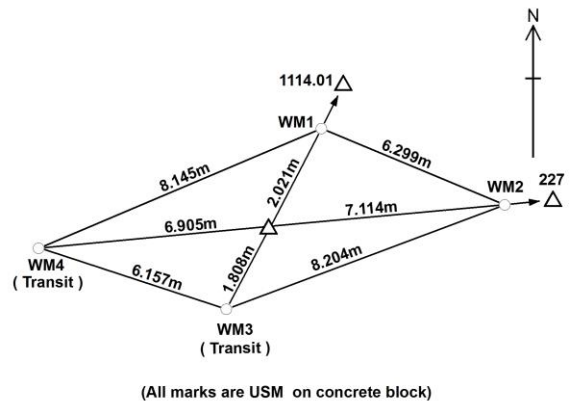

LOCATION MAP (Scale 1:20000)

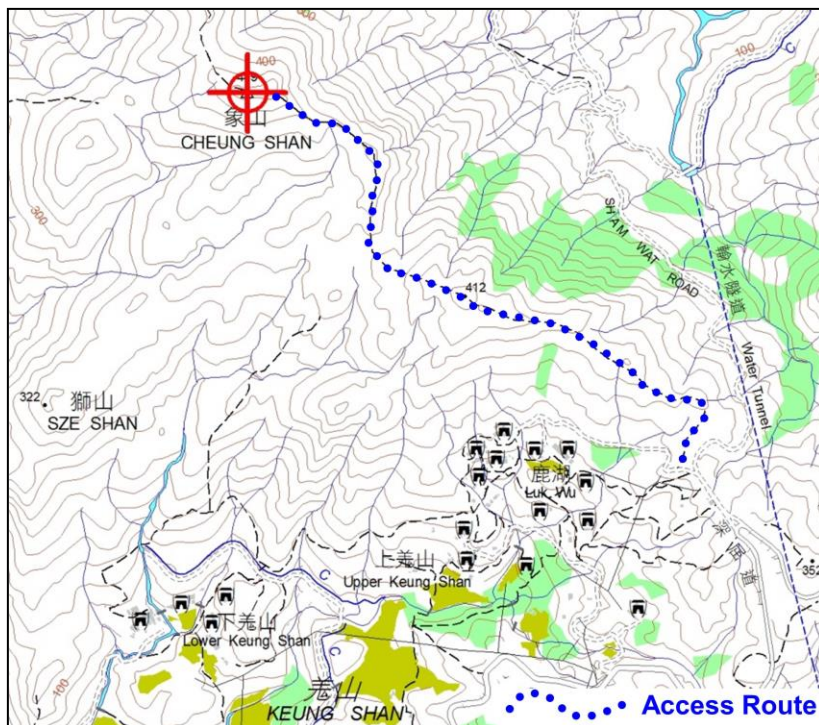

GRID BEARINGS TO ADJACENT TRIGS.

<b>85</b>	<b>209° 16' 25"</b>
<b>86</b>	<b>265° 48' 33"</b>
<b>227</b>	<b>83° 57' 26"</b>
<b>228</b>	<b>130° 23' 26"</b>

**REMARKS:**

Date of Construction : Dec 1984

Type of Mark :  
Type A Beacon