

TRIGONOMETRICAL STATION SUMMARY

STATION NO. : **227** (FORMER NO. : _____)

SURVEY SHEET NO. : **9-SE-16B**

TRIG. NAME : **NGONG PING**

LOCALITY : **NEI LAK SHAN, LANTAU**

HK 80 DATUM	<p>HK 1980 GRID COORDINATES : N = 813 832.053 m, E = 808 817.496 m, Class : H2</p> <p>Ht = 752.0 m above HKPD and measured to the top of mark, Class : V5</p> <p>SCALE FACTOR : + 9.6 ppm to measured distance to give Grid Distance</p> <p>GRID CONVERGENCE : - 06' 08.9" to Grid Bearings to give Azimuth</p>
WGS 84 DATUM	<p>GEOGRAPHICAL COORDINATES : Lat = 22° 15' 47.10319" N, Long = 113° 54' 37.97172" E, Class : GH3</p> <p>Ht = 748.269 m above Ellipsoid and measured to the top of mark, Class : GV3</p> <p>Reference Frame = ITRF96</p> <p>UTM GRID COORDINATES : 2 464 835 mN, 799 964 mE</p> <p>UTM GRID REFERENCE : 49Q GE 999 648</p>

STATION PHOTO



REFERENCE MARKS DIAGRAM

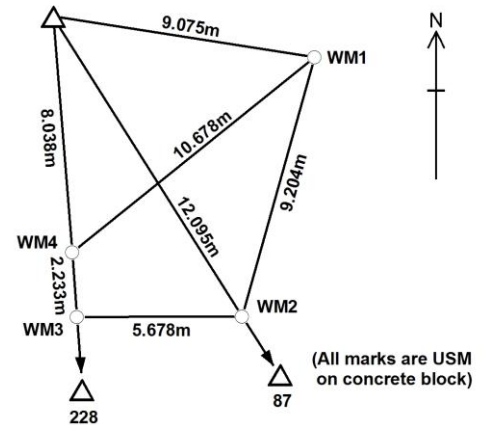

LOCATION MAP (Scale 1:20000)

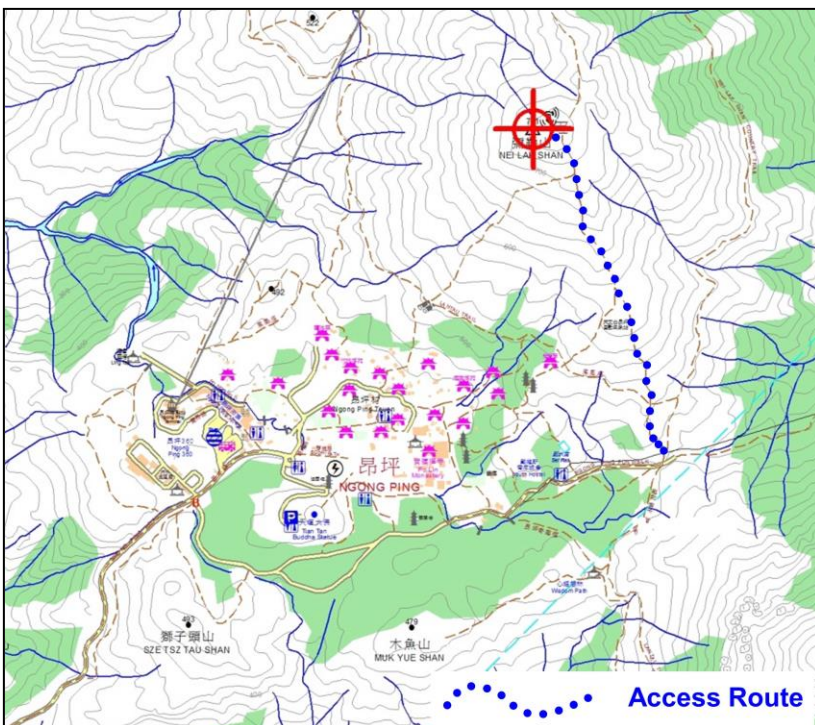

GRID BEARINGS TO ADJACENT TRIGS.

236	36° 56' 13"
256	98° 33' 04"
87	147° 38' 49"
228	175° 33' 52"

REMARKS:

Date of Construction : Dec 1984

Type of Mark :
Type A Beacon