

TRIGONOMETRICAL STATION SUMMARY

STATION NO. : 307 (FORMER NO. : _____)

CLASS : _____

TRIG. NAME : YUEN TAU SHAN

LOCALITY : YUEN LONG

HK 80 DATUM	<p>HK 1980 GRID COORDINATES : N = <u>832 608.514</u> m , E = <u>815 355.445</u> m , Ht = <u>376.1</u> m (1)</p> <p style="font-size: small;">Note (1) : Height is above the HKPD and measured to the top of mark.</p> <p>LEVEL ACCURACY : _____</p> <p>SCALE FACTOR : + <u>5.6</u> ppm to measured distance to give Grid Distance</p> <p>GRID CONVERGENCE : <u>- 4' 44.8"</u> to Grid Bearings to give Azimuth</p>
WGS 84 DATUM	<p>GEOGRAPHICAL COORDINATES : Lat _____ N, Long _____ E, Ht= _____ m (2)</p> <p style="font-size: small;">Note (2) : Height is above the WGS 84 Ellipsoid and measured to the top of mark.</p> <p>GPS ACCURACY : _____</p> <p>REFERENCE FRAME : _____</p> <p>UTM GRID COORDINATES : <u>2 483 759</u> mN <u>806 109</u> mE</p> <p>UTM GRID REFERENCE : <u>49Q HE 061 838</u></p>

STATION DIAGRAM

Date of Construction : 16/06/1987 Type of Mark : Beacon

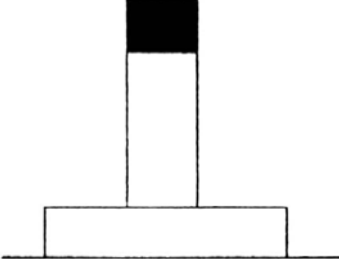

Side view

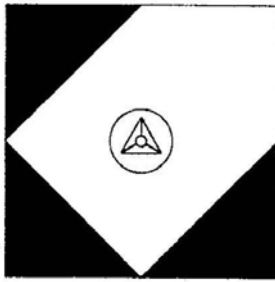

Plan view

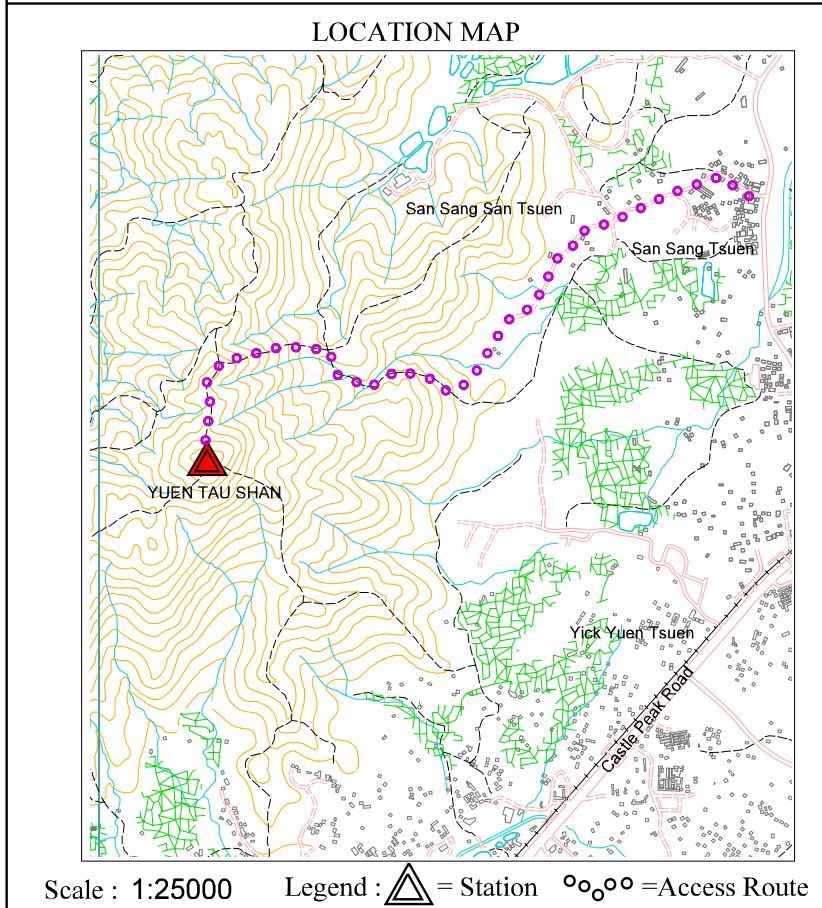
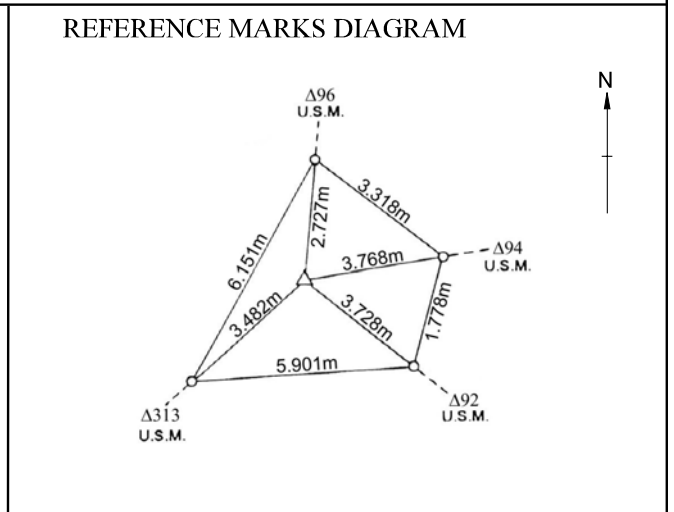

GRID BEARINGS TO ADJACENT TRIGS.	
96	25° 02' 20"
93	38° 35' 19"
94	83° 52' 02"
92	111° 17' 08"
LAST MAINTENANCE RECORD :	
Last visit on : <u>23/02/2002</u>	
REMARKS :	
1) Fixing of witness marks on 8/95.	