

TRIGONOMETRICAL STATION SUMMARY

STATION NO. : 325 (FORMER NO. : _____)

CLASS : _____

TRIG. NAME : SHA CHAU

LOCALITY : SHA CHAU

HK 80 DATUM	HK 1980 GRID COORDINATES :	N = <u>822 696.944</u> m , E = <u>806 750.654</u> m , Ht = <u>19.2</u> m ⁽¹⁾
	LEVEL ACCURACY :	Note (1) : Height is above the HKPD and measured to the top of mark.
	SCALE FACTOR :	+ <u>10.9</u> ppm to measured distance to give Grid Distance
	GRID CONVERGENCE :	<u>-06'34.4"</u> to Grid Bearings to give Azimuth
WGS 84 DATUM	GEOGRAPHICAL COORDINATES :	Lat <u>22° 20' 35.17582"</u> N, Long <u>113° 53' 25.19654"</u> E, Ht= <u>15.186</u> m ⁽²⁾
	GPS ACCURACY :	Note (2) : Height is above the WGS 84 Ellipsoid and measured to the top of mark.
	UTM GRID COORDINATES :	<u>2 473 661</u> mN <u>797 710</u> mE
	UTM GRID REFERENCE :	<u>49Q GE 977 737</u>
REFERENCE FRAME : ITRF96		

STATION DIAGRAM

Date of Construction : 01/09/1994 Type of Mark : Beacon

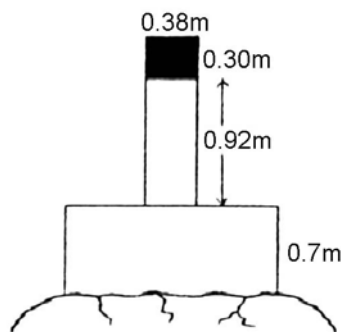

Side view

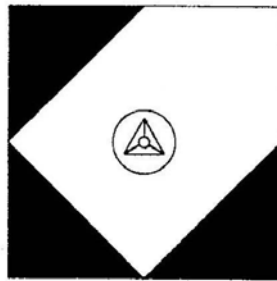

Plan view

REFERENCE MARKS DIAGRAM

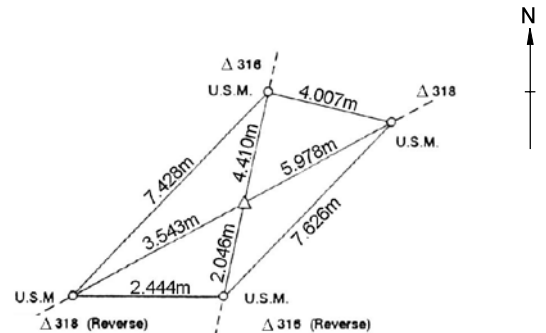

LOCATION MAP

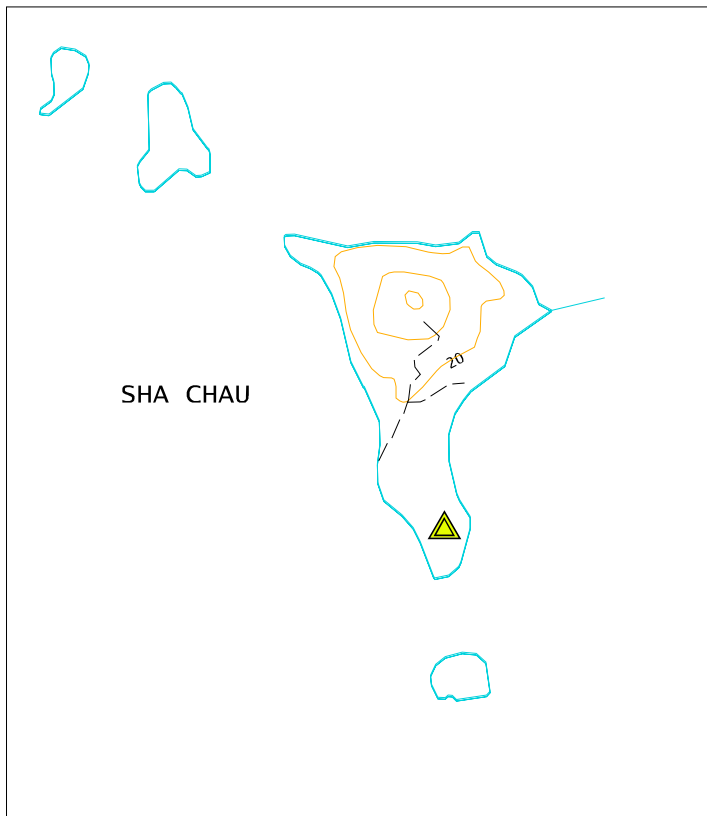

Scale : 1:10000 Legend : = Station = Access Route

GRID BEARINGS TO ADJACENT TRIGS.

316	12° 59' 20"
314	26° 48' 16"
315	32° 06' 51"
318	55° 06' 03"

LAST MAINTENANCE RECORD :

Last visit on : 28/05/2002

REMARKS :

- 1) Fixing of witness marks on 9/95.
- 2) The HK 1980 grid coordinates of this station are transformed from GPS surveyed geodetic coordinates.

Prepared by : LOO C.Y.

Checked by : LAO K.F.

Approved by : WONG Y.K., LS/G(NT)
Date : 25/06/2003

Geodetic Survey Section
SMO, Lands Department
Copyright reserved