

# TRIGONOMETRICAL STATION SUMMARY

STATION NO. : **418** (FORMER NO. : \_\_\_\_\_)

SURVEY SHEET NO. : **2-SE-9C**

TRIG. NAME : **HADDEN HILL**

LOCALITY : **SAN TIN**

<b>HK 80 DATUM</b>	<p>HK 1980 GRID COORDINATES : N = <b>839 734.074</b> m, E = <b>827 251.164</b> m, Class : <b>H2</b></p> <p>Ht = <b>222.9</b> m above HKPD and measured to the top of mark, Class : <b>V5</b></p> <p>SCALE FACTOR : <b>+ 1.1</b> ppm to measured distance to give Grid Distance</p> <p>GRID CONVERGENCE : <b>- 02' 06.4"</b> to Grid Bearings to give Azimuth</p>
------------------------	--

<b>WGS 84 DATUM</b>	<p>GEOGRAPHICAL COORDINATES : Lat = _____ N, Long = _____ E, Class : _____</p> <p>Ht = _____ m above Ellipsoid and measured to the top of mark, Class : _____</p> <p>Reference Frame = _____</p> <p>UTM GRID COORDINATES : <b>2 490 772</b> mN, <b>200 516</b> mE</p> <p>UTM GRID REFERENCE : <b>50Q KK 005 907</b></p>
-------------------------	---

STATION PHOTO

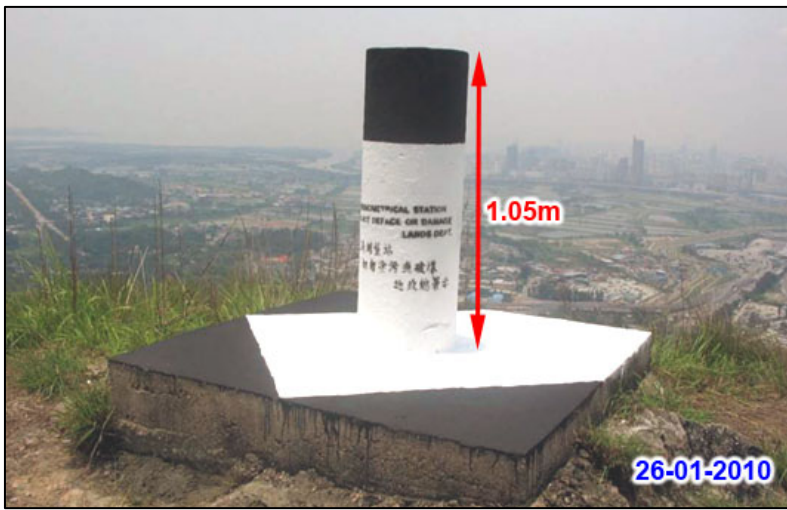

REFERENCE MARKS DIAGRAM

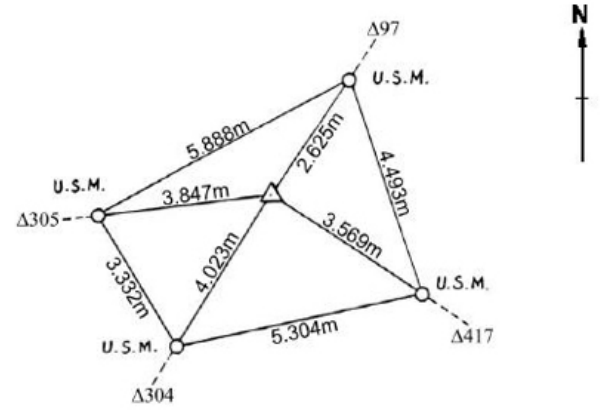

LOCATION MAP (Scale 1:20000)

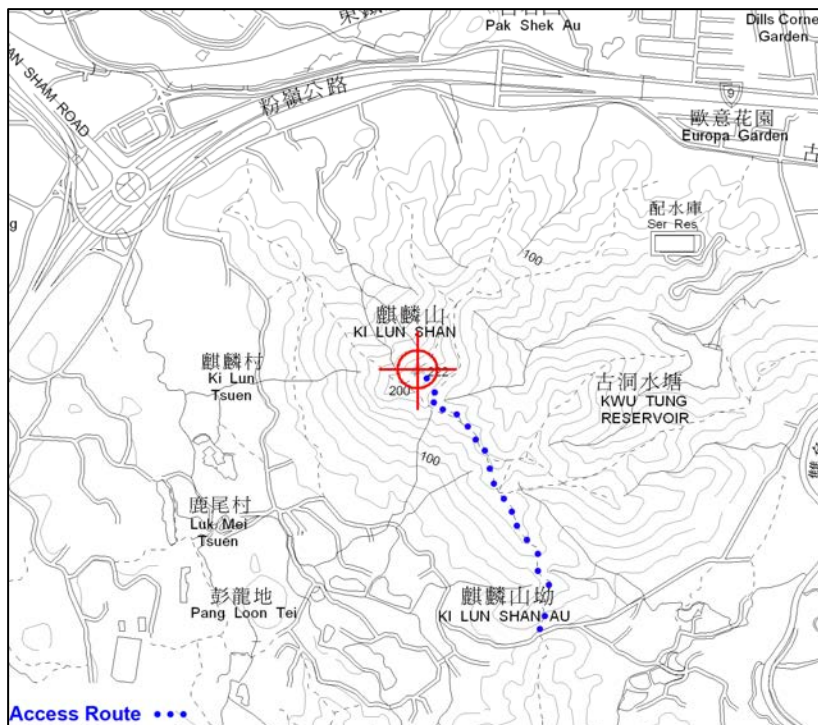

GRID BEARINGS TO ADJACENT TRIGS.

<b>97</b>	<b>32° 47' 33"</b>
<b>419</b>	<b>75° 40' 10"</b>
<b>420</b>	<b>95° 29' 54"</b>
<b>417</b>	<b>124° 31' 54"</b>

**REMARKS:**

**Date of Construction : 1976**

**Type of Mark :  
Type A Beacon**