

# TRIGONOMETRICAL STATION SUMMARY

STATION NO. : 502 (FORMER NO. : \_\_\_\_\_)

CLASS : \_\_\_\_\_

TRIG. NAME : WONG UK, SHA TIN

LOCALITY : SHA TIN

<b>HK 80 DATUM</b>	<b>HK 1980 GRID COORDINATES</b> : N = <u>827 060.223</u> m , E = <u>838 509.484</u> m , Ht = <u>71.1</u> m (1) <i>Note (1) : Height is above the HKPD and measured to the top of mark.</i> <b>LEVEL ACCURACY</b> : _____ <b>SCALE FACTOR</b> : + <u>0.0</u> ppm to measured distance to give Grid Distance <b>GRID CONVERGENCE</b> : + <u>0' 24.2"</u> to Grid Bearings to give Azimuth
<b>WGS 84 DATUM</b>	<b>GEOGRAPHICAL COORDINATES</b> : Lat _____ N, Long _____ E, Ht = _____ m (2) <i>Note (2) : Height is above the WGS 84 Ellipsoid and measured to the top of mark.</i> <b>GPS ACCURACY</b> : _____ <b>UTM GRID COORDINATES</b> : <u>2 477 881</u> mN <u>211 541</u> mE <b>UTM GRID REFERENCE</b> : <u>50Q KK 115 779</u> <b>REFERENCE FRAME</b> : _____

**STATION DIAGRAM**

Date of Construction : 01/01/1976      Type of Mark : Beacon

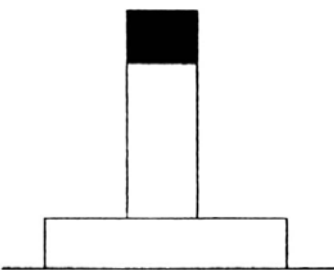

Side view

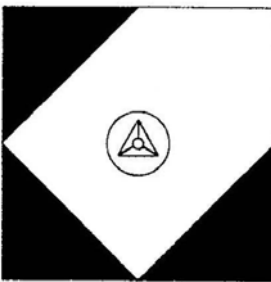

Plan view

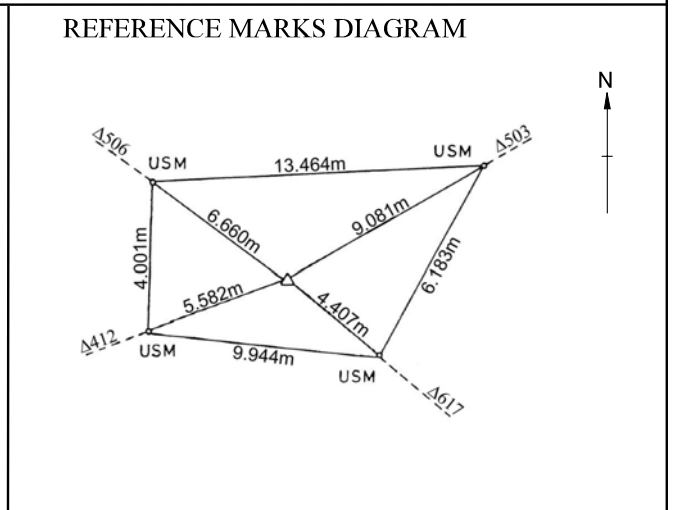

**LOCATION MAP**

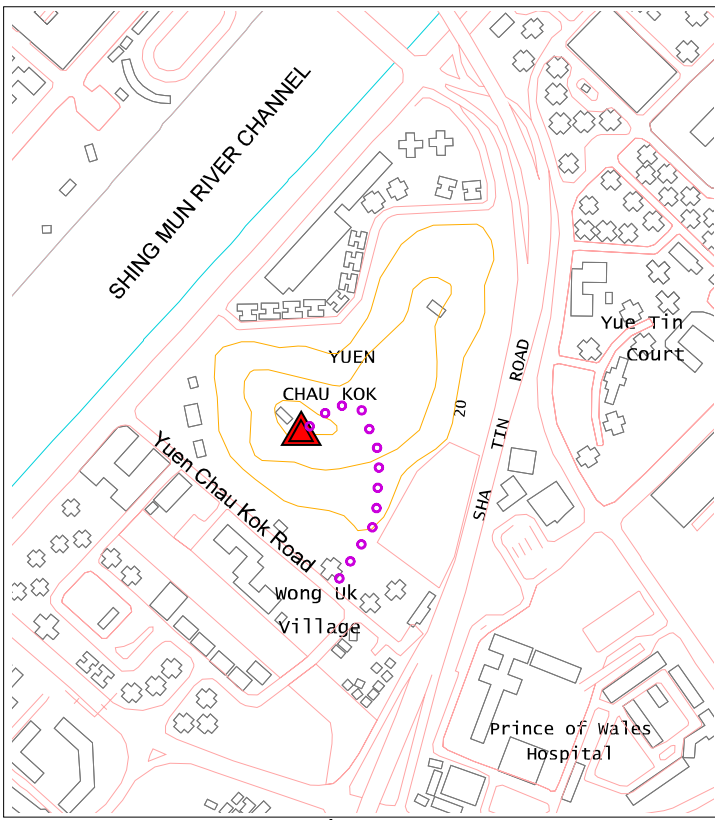

Scale : 1:10000      Legend : = Station      = Access Route

**GRID BEARINGS TO ADJACENT TRIGS.**

503	70° 14' 46"
617	107° 33' 53"
73	219° 54' 19"
412	276° 36' 33"

**LAST MAINTENANCE RECORD :**  
 Last visit on : 05/01/2001

- REMARKS :**
- 1) Walking from Yuen Chau Kok Road uphill via concrete footpath.
  - 2) Fixing of witness marks on 2/97.