

# TRIGONOMETRICAL STATION SUMMARY

STATION NO. : **503** (FORMER NO. : \_\_\_\_\_)

SURVEY SHEET NO. : **7-SE-8C**

TRIG. NAME : **TURRET HILL**

LOCALITY : **SHA TIN**

<b>HK 80 DATUM</b>	HK 1980 GRID COORDINATES : N = <b>828 005.875</b> m, E = <b>841 142.771</b> m, Class : <b>H2</b>
	Ht = <b>400.9</b> m above HKPD and measured to the top of mark, Class : <b>V6</b>
	SCALE FACTOR : <b>+ 0.2</b> ppm to measured distance to give Grid Distance
	GRID CONVERGENCE : <b>+ 00' 59.2"</b> to Grid Bearings to give Azimuth
<b>WGS 84 DATUM</b>	GEOGRAPHICAL COORDINATES : Lat = _____ N, Long = _____ E, Class : _____
	Ht = _____ m above Ellipsoid and measured to the top of mark, Class : _____
	Reference Frame = _____
	UTM GRID COORDINATES : <b>2 478 777</b> mN, <b>214 193</b> mE
	UTM GRID REFERENCE : <b>50Q KK 141 787</b>

STATION PHOTO



REFERENCE MARKS DIAGRAM

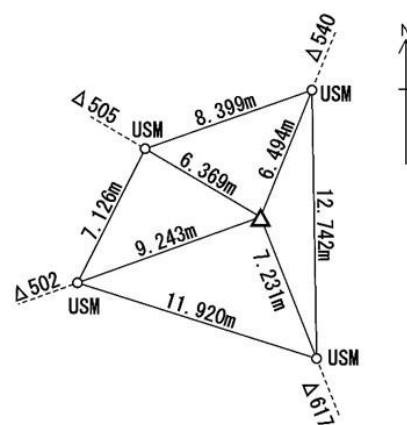

LOCATION MAP (Scale 1:20000)

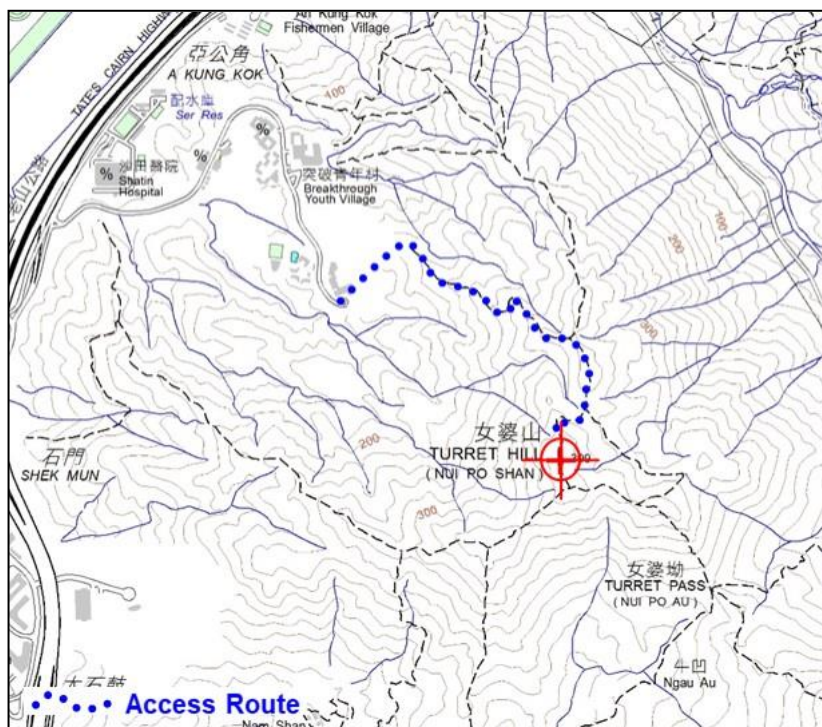

GRID BEARINGS TO ADJACENT TRIGS.

<b>512</b>	<b>05° 32' 48"</b>
<b>540</b>	<b>22° 04' 46"</b>
<b>652</b>	<b>78° 21' 37"</b>
<b>617</b>	<b>158° 21' 15"</b>

## REMARKS:

Date of Construction : 1976

Type of Mark :  
Type A Beacon

Drive along A Kung Kok Shan Road & stop at the end adjoining the artificial slope. Walking about 45 min. to Trig. Station.

Fixing of witness marks on 5/97