

TRIGONOMETRICAL STATION SUMMARY

STATION NO. : **537** (FORMER NO. : _____)

SURVEY SHEET NO. : **4-SW-5D**

TRIG. NAME : **TAI LENG**

LOCALITY : **WONG CHUK KOK**

HK 80 DATUM	HK 1980 GRID COORDINATES : N = 840 814.425 m, E = 852 226.373 m, Class : H2
	Ht = 153.4 m above HKPD and measured to the top of mark, Class : V6
	SCALE FACTOR : + 3.0 ppm to measured distance to give Grid Distance
	GRID CONVERGENCE : + 03' 28.0" to Grid Bearings to give Azimuth
WGS 84 DATUM	GEOGRAPHICAL COORDINATES : Lat = _____ N, Long = _____ E, Class : _____
	Ht = _____ m above Ellipsoid and measured to the top of mark, Class : _____
	Reference Frame = _____
	UTM GRID COORDINATES : 2 491 382 mN, 225 522 mE
	UTM GRID REFERENCE : 50Q KK 255 913

STATION PHOTO



REFERENCE MARKS DIAGRAM

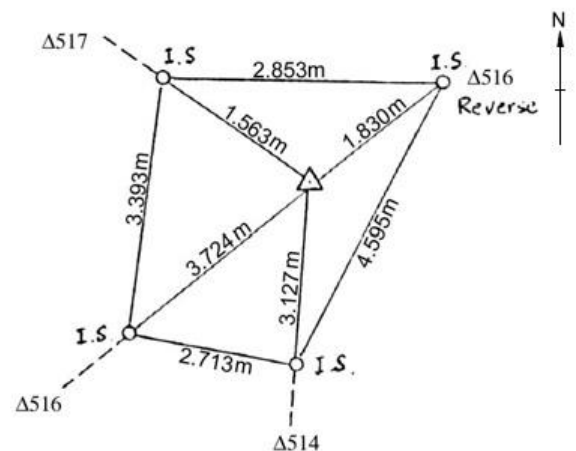

LOCATION MAP (Scale 1:20000)



GRID BEARINGS TO ADJACENT TRIGS.

62	99° 44' 56"
63	151° 36' 23"
514	198° 09' 52"
64	198° 27' 04"

REMARKS:

Date of Construction : Dec 1986

Type of Mark :

Type A Beacon