

# TRIGONOMETRICAL STATION SUMMARY

STATION NO. : **61** (FORMER NO. : \_\_\_\_\_)

SURVEY SHEET NO. : **4-NW-13B**

TRIG. NAME : **KAT O CHAU**

LOCALITY : **CROOKED ISLAND**

<b>HK 80 DATUM</b>	HK 1980 GRID COORDINATES : N = <b>845 363.016</b> m, E = <b>849 169.878</b> m, Class : <b>H1</b> Ht = <b>123.4</b> m above HKPD and measured to the top of mark, Class : <b>V5</b> SCALE FACTOR : <b>+ 1.9</b> ppm to measured distance to give Grid Distance GRID CONVERGENCE : <b>+ 02' 47.4"</b> to Grid Bearings to give Azimuth
--------------------	---

<b>WGS 84 DATUM</b>	GEOGRAPHICAL COORDINATES : Lat = _____ N, Long = _____ E, Class : _____ Ht = _____ m above Ellipsoid and measured to the top of mark, Class : _____ Reference Frame = _____ UTM GRID COORDINATES : <b>2 495 990</b> mN, <b>222 551</b> mE UTM GRID REFERENCE : <b>50Q KK 225 959</b>
---------------------	--

STATION PHOTO



REFERENCE MARKS DIAGRAM

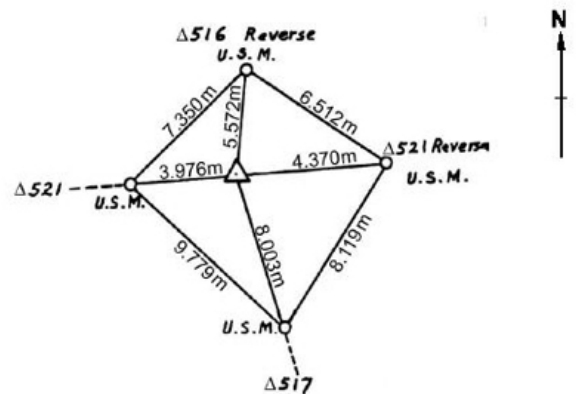

LOCATION MAP (Scale 1:20000)

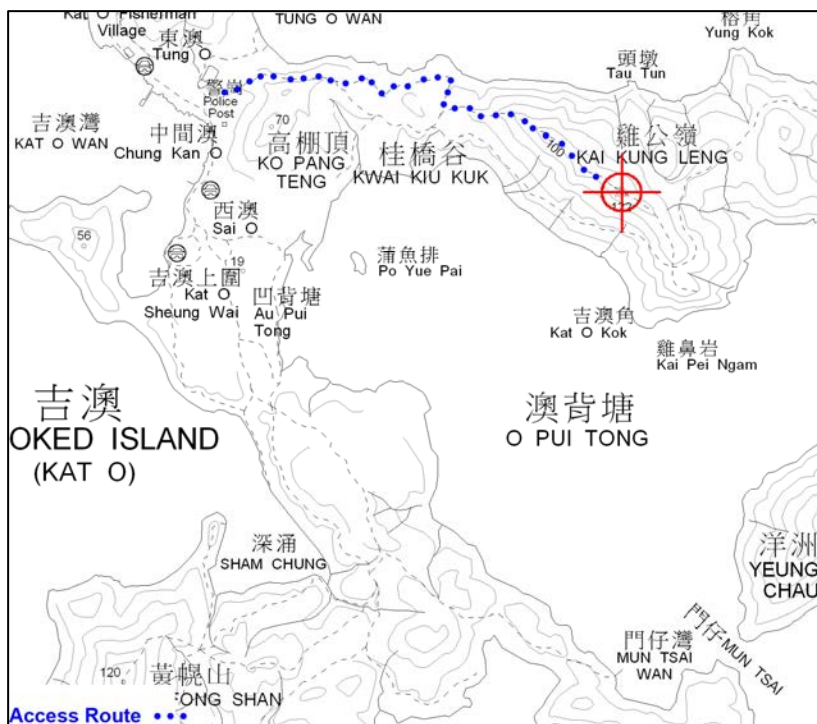

GRID BEARINGS TO ADJACENT TRIGS.

<b>62</b>	<b>130° 29' 40"</b>
<b>537</b>	<b>146° 06' 01"</b>
<b>517</b>	<b>160° 32' 26"</b>
<b>516</b>	<b>184° 02' 59"</b>

**REMARKS:**

**Date of Construction : 1976**

**Type of Mark :  
Type A Beacon**

**Regular ferry service available from Sha Tau Kok.**