

TRIGONOMETRICAL STATION SUMMARY

STATION NO. : **65** (FORMER NO. : _____)

SURVEY SHEET NO. : **3-SE-19A**

TRIG. NAME : **PAT SIN LENG**

LOCALITY : **PAT SIN LENG, TAI PO**

HK 80 DATUM	<p>HK 1980 GRID COORDINATES : N = 838 381.226 m, E = 842 150.789 m, Class : H1</p> <p>Ht = 512.2 m above HKPD and measured to the top of mark, Class : V5</p> <p>SCALE FACTOR : + 0.4 ppm to measured distance to give Grid Distance</p> <p>GRID CONVERGENCE : + 01' 13.0" to Grid Bearings to give Azimuth</p>
WGS 84 DATUM	<p>GEOGRAPHICAL COORDINATES : Lat = _____ N, Long = _____ E, Class : _____</p> <p>Ht = _____ m above Ellipsoid and measured to the top of mark, Class : _____</p> <p>Reference Frame = _____</p> <p>UTM GRID COORDINATES : 2 489 138 mN, 215 397 mE</p> <p>UTM GRID REFERENCE : 50Q KK 153 891</p>

STATION PHOTO



REFERENCE MARKS DIAGRAM

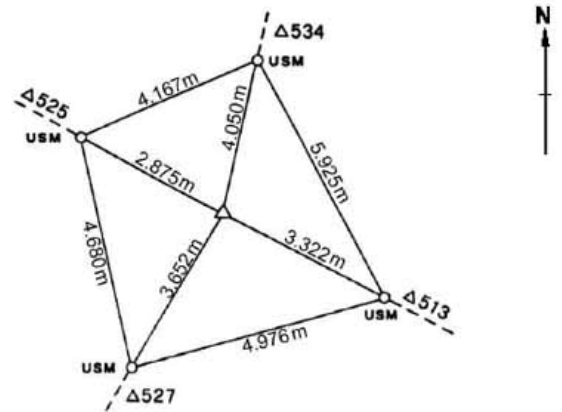

LOCATION MAP (Scale 1:20000)

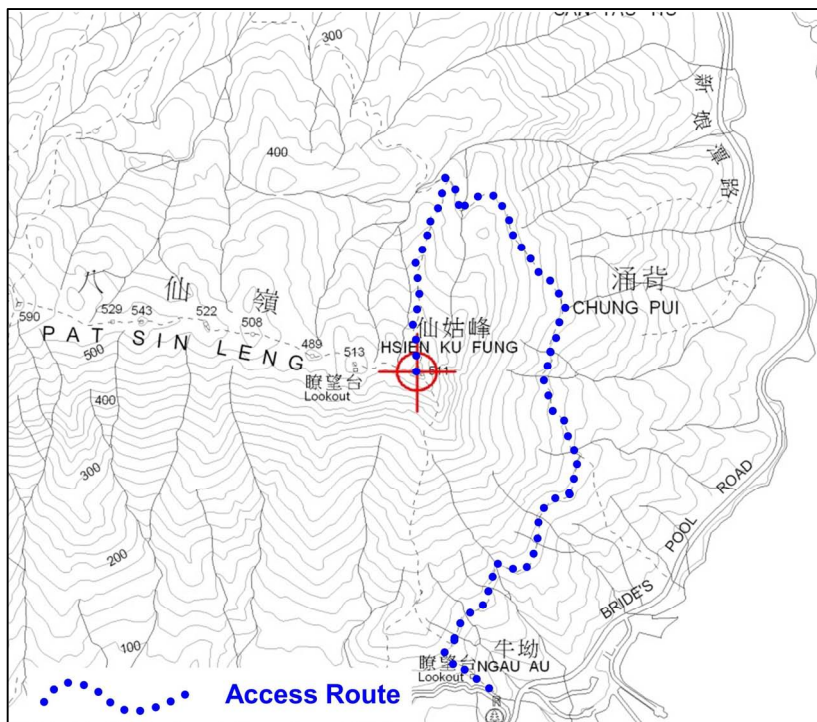

GRID BEARINGS TO ADJACENT TRIGS.

534	11° 29' 07"
519	41° 19' 44"
516	83° 49' 37"
513	118° 05' 04"

REMARKS:

Date of Construction : Jan 1976

Type of Mark :
Type A Beacon