

TRIGONOMETRICAL STATION SUMMARY

STATION NO. : **93** (FORMER NO. : _____)

SURVEY SHEET NO. : **6-NW-2D**

TRIG. NAME : **TUNG TAU TSUEN**

LOCALITY : **TIN SHUI WAI**

HK 80 DATUM	HK 1980 GRID COORDINATES : N = 834 994.638 m, E = 817 259.487 m, Class : H1
	Ht = 30.6 m above HKPD and measured to the top of mark, Class : V5
	SCALE FACTOR : + 4.7 ppm to measured distance to give Grid Distance
	GRID CONVERGENCE : - 04' 19.6" to Grid Bearings to give Azimuth
WGS 84 DATUM	GEOGRAPHICAL COORDINATES : Lat = _____ N, Long = _____ E, Class : _____
	Ht = _____ m above Ellipsoid and measured to the top of mark, Class : _____
	Reference Frame = _____
	UTM GRID COORDINATES : 2 486 187 mN, 807 964 mE
	UTM GRID REFERENCE : 49Q HE 079 861

STATION PHOTO

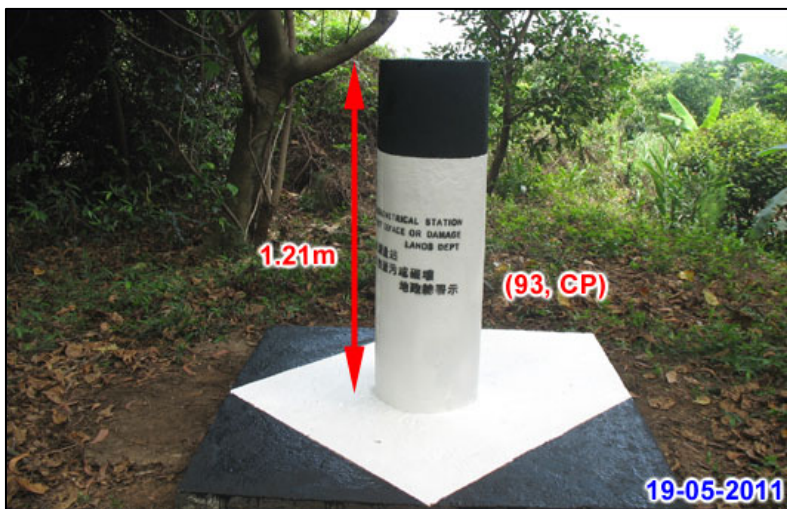

REFERENCE MARKS DIAGRAM

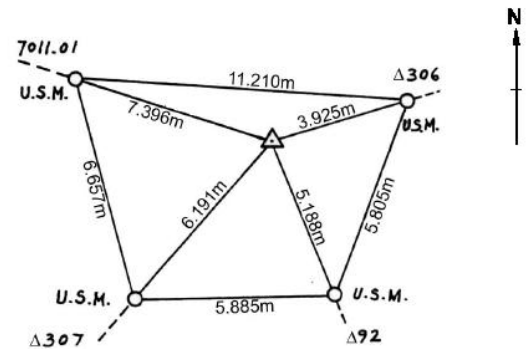

LOCATION MAP (Scale 1:2000)



GRID BEARINGS TO ADJACENT TRIGS.

96	13° 31' 25"
306	79° 20' 48"
92	157° 05' 27"
309	185° 34' 21"

REMARKS:

Type of Mark :
Type A Beacon (CP)

Fixing of witness marks on 7/90.

All measurements shown are in horizontal distance unless otherwise specified.