

SATELLITE POSITIONING REFERENCE STATION SUMMARY

STATION NO. : HKWS (FORMER NO. : _____)

ACCURACY CLASS : _____

TRIG. NAME : WONG SHEK SATELLITE POSITIONING REFERENCE STATION

LOCALITY : WONG SHEK

| | |
|-------------------------|---|
| HK 80 DATUM | <p>HK 1980 GRID COORDINATES : N = <u>832 774.156</u> m , E = <u>852 585.076</u> m , Ht = <u>66.107</u> m (1)</p> <p style="text-align: center;"><i>Note (1) : Height is above the HKPD and measured to the top of mark.</i></p> <p>LEVEL ACCURACY : _____</p> <p>SCALE FACTOR : + <u>3.1</u> ppm to measured distance to give Grid Distance</p> <p>GRID CONVERGENCE : + <u>3' 32.1"</u> to Grid Bearings to give Azimuth</p> |
| WGS 84 DATUM | <p>GEOGRAPHICAL COORDINATES : Lat <u>22° 26'3.41646"</u> N, Long <u>114° 20'7.35829"</u> E, Ht = <u>63.789</u>m (2)</p> <p style="text-align: center;"><i>Note (2) : Height is above the WGS 84 Ellipsoid and measured to the top of mark.</i></p> <p>GPS ACCURACY : _____</p> <p>REFERENCE FRAME : ITRF96</p> <p>UTM GRID COORDINATES : <u>2 483 332</u> mN <u>225 730</u> mE</p> <p>UTM GRID REFERENCE : <u>50Q KK 257 833</u></p> |

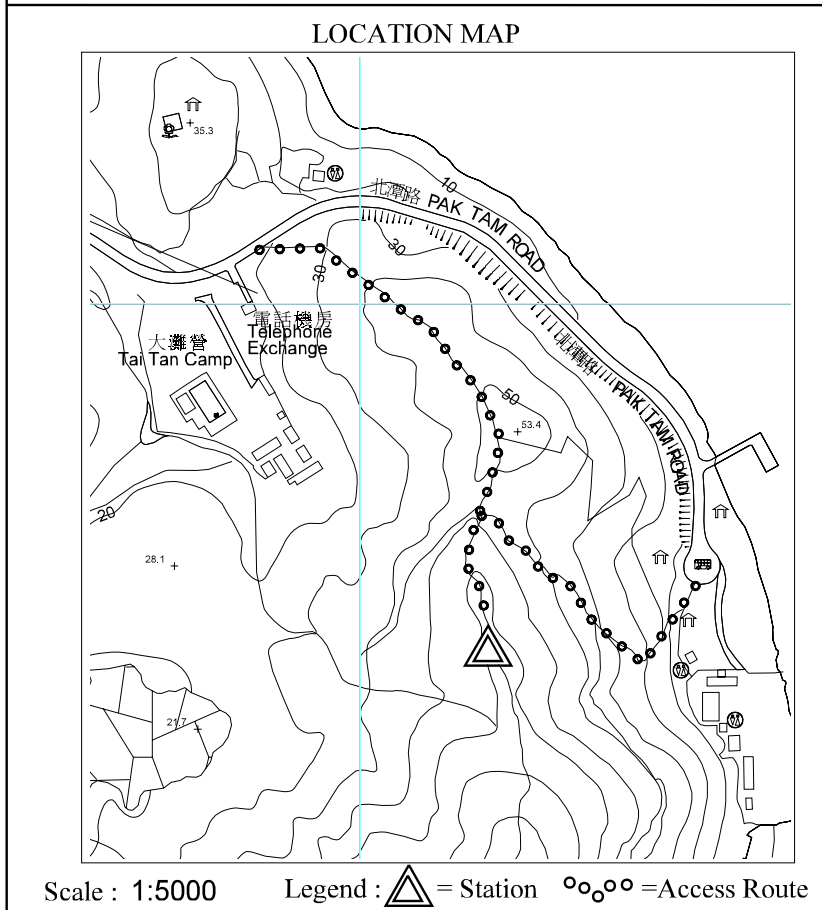
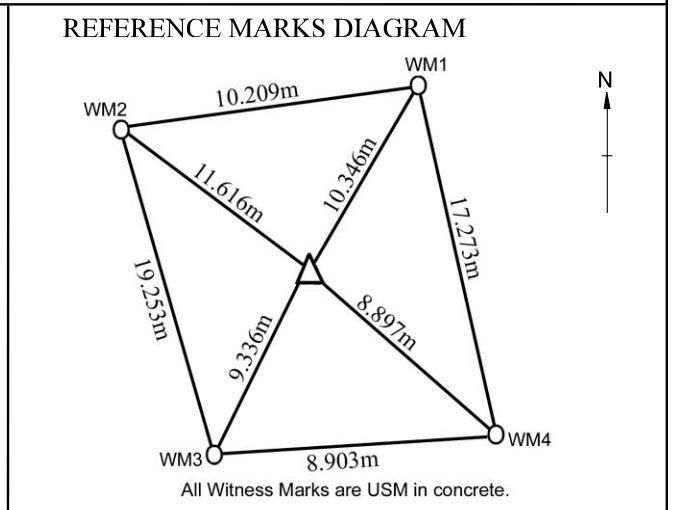
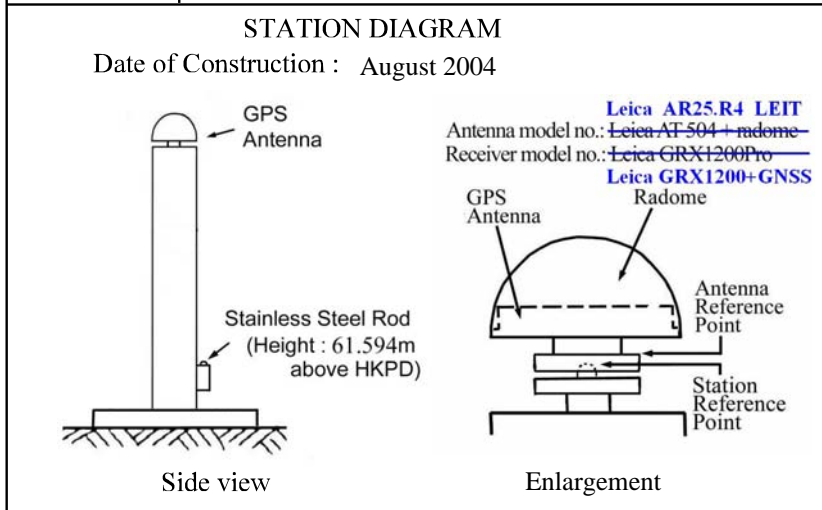

Draft for Equipment
Upgraded on 7-9-2011

LAST MAINTENANCE RECORD :

Last visit on : 14/10/2004

REMARKS :

- 1) The Station Reference Point (horizontal & vertical) is at the top of the nipple of the lower antenna mount.
- 2) The height from the Station Reference Point to the Antenna Reference Point (bottom of antenna) is 0.008m.
- 3) The HK 1980 grid coordinates of this station are transformed from GPS surveyed geodetic coordinates.