

# TRIGONOMETRICAL STATION SUMMARY

STATION NO. : **223** (FORMER NO. : \_\_\_\_\_)

SURVEY SHEET NO. : **13-NW-9B**

TRIG. NAME : **KEUNG SHAN**

LOCALITY : **KEUNG SHAN, LANTAU**

<b>HK 80 DATUM</b>	HK 1980 GRID COORDINATES : N = <b>810 393.471</b> m, E = <b>805 792.687</b> m, Class : <b>H2</b> Ht = <b>460.2</b> m above HKPD and measured to the top of mark, Class : <b>V5</b> SCALE FACTOR : <b>+ 11.8</b> ppm to measured distance to give Grid Distance GRID CONVERGENCE : <b>- 06' 48.3"</b> to Grid Bearings to give Azimuth
--------------------	--

<b>WGS 84 DATUM</b>	GEOGRAPHICAL COORDINATES : Lat = <b>22° 13' 55.13219"</b> N, Long = <b>113° 52' 52.55966"</b> E, Class : <b>GH3</b> Ht = <b>456.413</b> m above Ellipsoid and measured to the top of mark, Class : <b>GV3</b> Reference Frame = <b>ITRF96</b> UTM GRID COORDINATES : <b>2 461 331</b> mN, <b>797 010</b> mE UTM GRID REFERENCE : <b>49Q GE 970 613</b>
---------------------	--

STATION PHOTO



REFERENCE MARKS DIAGRAM

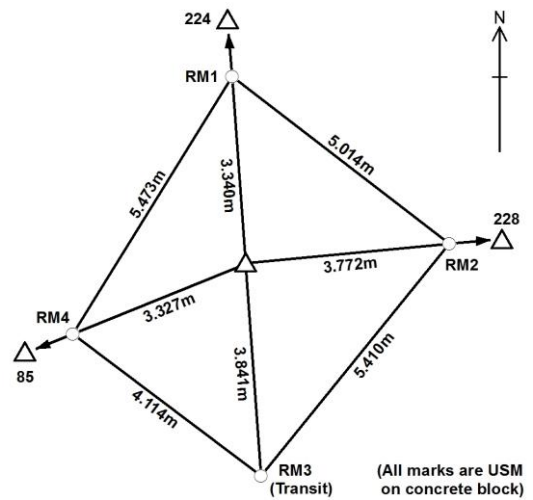

LOCATION MAP (Scale 1:20000)

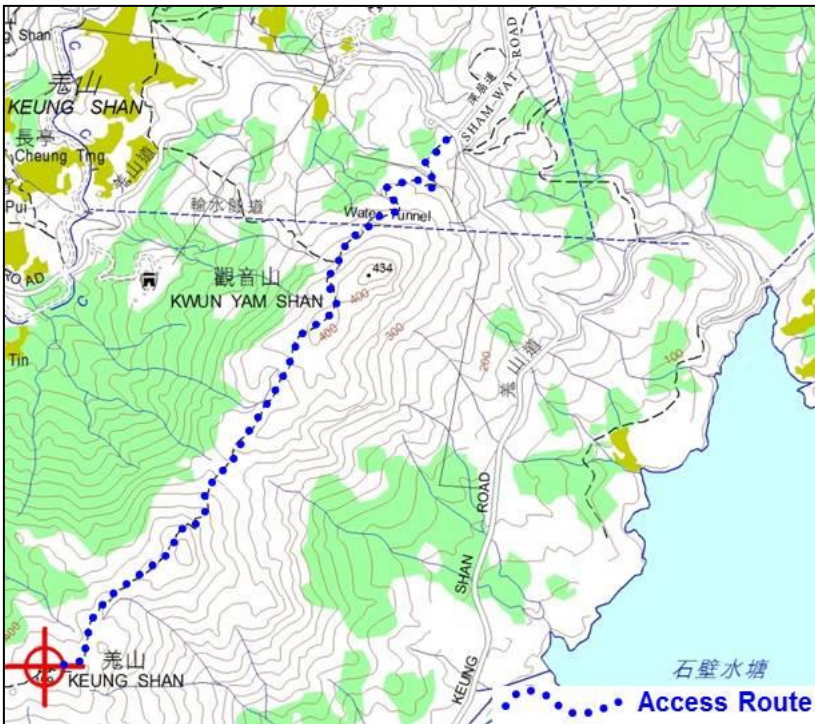

GRID BEARINGS TO ADJACENT TRIGS.

<b>227</b>	<b>41° 20' 13"</b>
<b>87</b>	<b>64° 37' 30"</b>
<b>228</b>	<b>86° 42' 27"</b>
<b>84</b>	<b>156° 21' 32"</b>

REMARKS:

Type of Mark :  
Type A Beacon