

TRIGONOMETRICAL STATION SUMMARY

STATION NO. : **311** (FORMER NO. : _____)

SURVEY SHEET NO. : **6-SW-19C**

TRIG. NAME : **SIU LAM SERVICE RESERVOIR**

LOCALITY : **SIU LAM**

HK 80 DATUM	HK 1980 GRID COORDINATES : N = 825 510.438 m, E = 819 990.406 m, Class : H2
	Ht = 142.3 m above HKPD and measured to the top of mark, Class : V6
	SCALE FACTOR : + 3.4 ppm to measured distance to give Grid Distance
	GRID CONVERGENCE : - 03' 42.2" to Grid Bearings to give Azimuth
WGS 84 DATUM	GEOGRAPHICAL COORDINATES : Lat = 22° 22' 7.27708" N, Long = 114° 1' 7.78456" E, Class : GH3
	Ht = 138.791 m above Ellipsoid and measured to the top of mark, Class : GV3
	Reference Frame = ITRF96
	UTM GRID COORDINATES : 2 476 678 mN, 192 983 mE
	UTM GRID REFERENCE : 50Q JK 929 766

STATION PHOTO

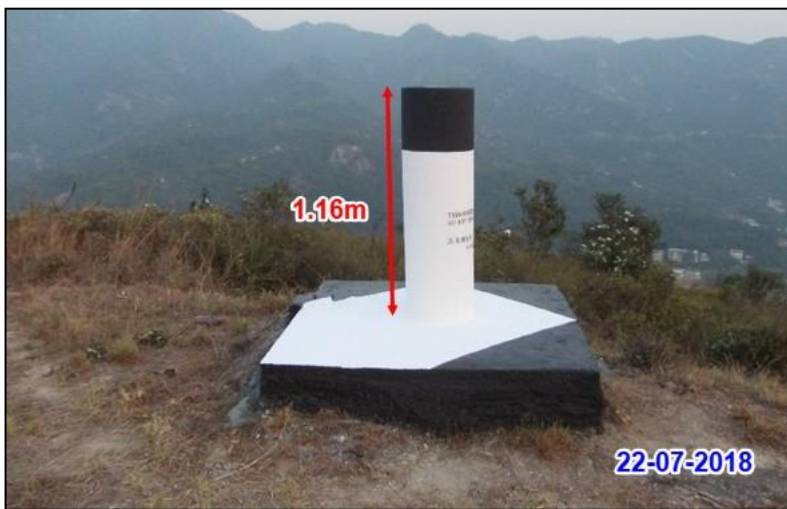

REFERENCE MARKS DIAGRAM

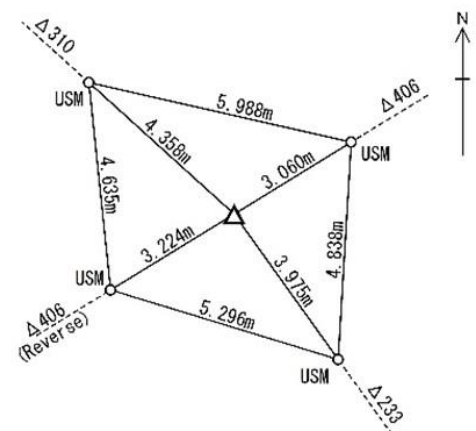

LOCATION MAP (Scale 1:10000)

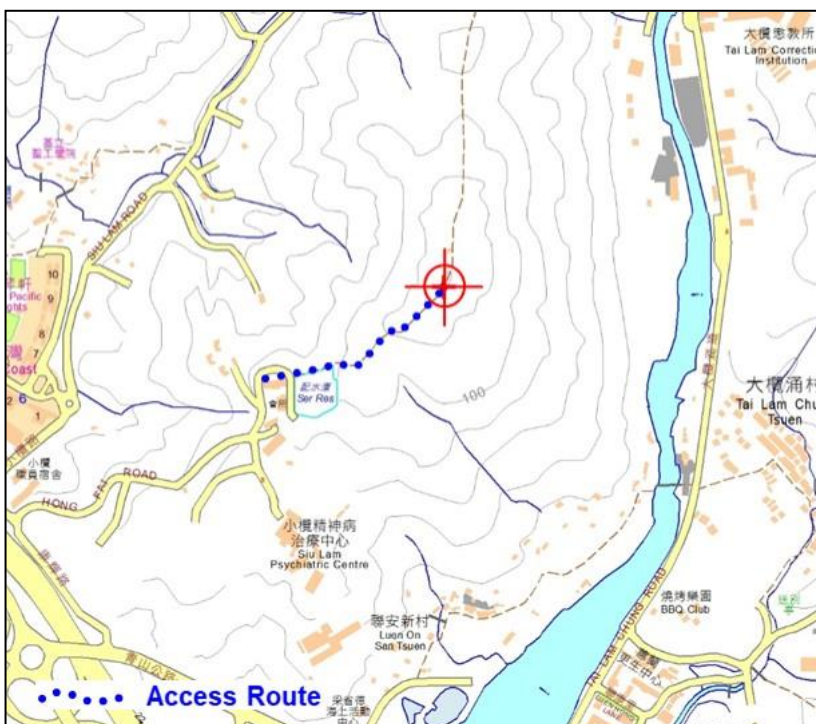

GRID BEARINGS TO ADJACENT TRIGS.

406	58° 29' 22"
91	78° 50' 29"
233	144° 20' 16"
88	194° 09' 01"

REMARKS:

Date of Construction : 1976

Type of Mark :

Type A Beacon

Witness marks were installed in 9/97