

TRIGONOMETRICAL STATION SUMMARY

STATION NO. : **329** (FORMER NO. : _____)

SURVEY SHEET NO. : **2-SW-22B**

TRIG. NAME : **LAM HANG SHAN**

LOCALITY : **LAU FAU SHAN**

HK 80 DATUM	<p>HK 1980 GRID COORDINATES : N = 836 861.959 m, E = 817 394.757 m, Class : N.A. Transformed from WGS84 (ITRF96) Ht = 76.550 m above HKPD and measured to the top of mark, Class : V3</p> <p>SCALE FACTOR : + 4.6 ppm to measured distance to give Grid Distance</p> <p>GRID CONVERGENCE : - 04' 18.0" to Grid Bearings to give Azimuth</p>
WGS 84 DATUM	<p>GEOGRAPHICAL COORDINATES : Lat = 22° 28' 16.21431" N, Long = 113° 59' 36.57324" E, Class : GH3 Ht = 72.681 m above Ellipsoid and measured to the top of mark, Class : GV3</p> <p>Reference Frame = ITRF96</p> <p>UTM GRID COORDINATES : 2 488 058 mN, 808 059 mE</p> <p>UTM GRID REFERENCE : 49Q HE 080 880</p>

STATION PHOTO



REFERENCE MARKS DIAGRAM

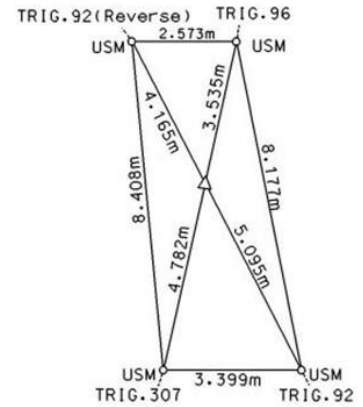

LOCATION MAP (Scale 1:10000)



GRID BEARINGS TO ADJACENT TRIGS.

96	23° 29' 45"
92	165° 32' 23"
307	205° 36' 55"
330	227° 33' 00"

REMARKS:

Date of Construction : Nov 2002

Type of Mark :
Type A Beacon

Ring-headed screws were installed.