

# TRIGONOMETRICAL STATION SUMMARY

STATION NO. : **411** (FORMER NO. : **TSUEN WAN**)

SURVEY SHEET NO. : **7-SW-11A**

TRIG. NAME : **FU YUNG SHAN NORTH**

LOCALITY : **CHUEN LUNG**

<b>HK 80 DATUM</b>	HK 1980 GRID COORDINATES : N = <b>827 162.316</b> m, E = <b>830 208.195</b> m, Class : <b>H2</b>
	Ht = <b>314.7</b> m above HKPD and measured to the top of mark, Class : <b>V5</b>
	SCALE FACTOR : <b>+ 0.5</b> ppm to measured distance to give Grid Distance
	GRID CONVERGENCE : <b>- 01' 26.3"</b> to Grid Bearings to give Azimuth
<b>WGS 84 DATUM</b>	GEOGRAPHICAL COORDINATES : Lat = _____ N, Long = _____ E, Class : _____
	Ht = _____ m above Ellipsoid and measured to the top of mark, Class : _____
	Reference Frame = _____
	UTM GRID COORDINATES : <b>2 478 138</b> mN, <b>203 238</b> mE
	UTM GRID REFERENCE : <b>50Q KK 032 781</b>

STATION PHOTO



REFERENCE MARKS DIAGRAM

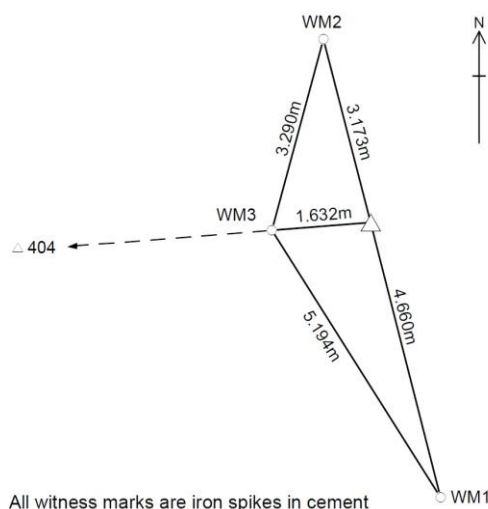

LOCATION MAP (Scale 1:20000)

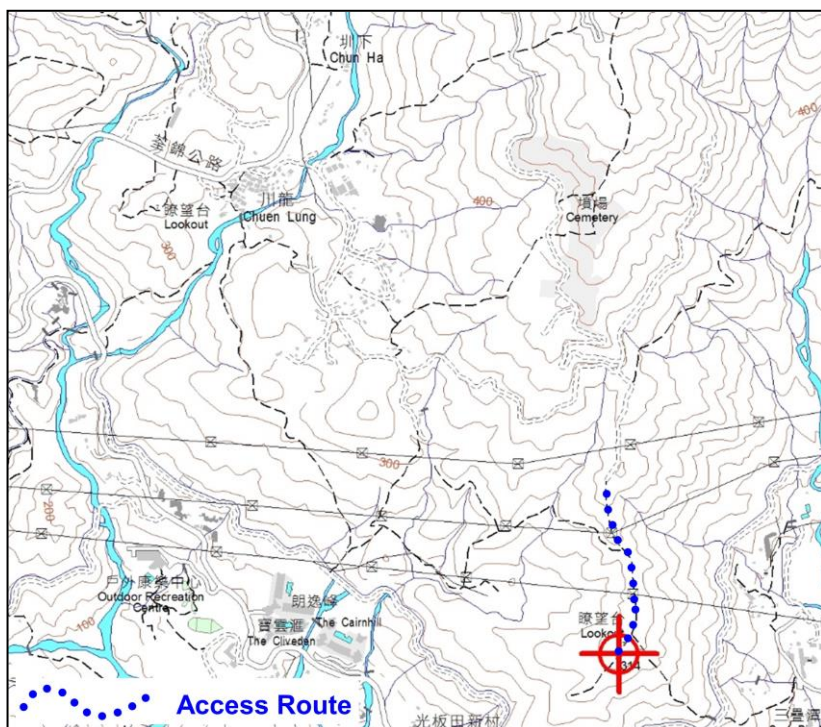

GRID BEARINGS TO ADJACENT TRIGS.

<b>67.2</b>	<b>12° 52' 31"</b>
<b>412</b>	<b>85° 25' 09"</b>
<b>410</b>	<b>111° 39' 06"</b>
<b>404</b>	<b>265° 29' 19"</b>

REMARKS:

Type of Mark :  
Type A Beacon

Drive along Route Twisk and turn right at Chuen Lung. Follow the track and stop before the restricted gate of Country Park Management Centre. After obtaining permission, drive to the end of the track. Then follow the footpath and walk for about 15 mins. to the trig.