

# TRIGONOMETRICAL STATION SUMMARY

STATION NO. : 434 (FORMER NO. : \_\_\_\_\_)

CLASS : \_\_\_\_\_

TRIG. NAME : TIN FU TSAI

LOCALITY : TIN FU TSAI

<b>HK 80 DATUM</b>	<p><b>HK 1980 GRID COORDINATES</b> : N = <u>828 623.036m</u> , E = <u>825 062.204m</u> , Ht = <u>465.6</u> m (1)</p> <p style="font-size: small;">Note (1) : Height is above the HKPD and measured to the top of mark.</p> <p><b>LEVEL ACCURACY</b> : _____</p> <p><b>SCALE FACTOR</b> : + <u>1.7</u> ppm to measured distance to give Grid Distance</p> <p><b>GRID CONVERGENCE</b> : <u>-02' 35.0"</u> to Grid Bearings to give Azimuth</p>
<b>WGS 84 DATUM</b>	<p><b>GEOGRAPHICAL COORDINATES</b> : Lat <u>22° 23' 48.61328"</u> N, Long <u>114° 4' 04.98362"</u> E, Ht=<u>462.178m</u> (2)</p> <p style="font-size: small;">Note (2) : Height is above the WGS 84 Ellipsoid and measured to the top of mark.</p> <p><b>GPS ACCURACY</b> : _____</p> <p><b>REFERENCE FRAME</b> : ITRF96</p> <p><b>UTM GRID COORDINATES</b> : <u>2 479 697</u> mN      <u>198 117</u> mE</p> <p><b>UTM GRID REFERENCE</b> : <u>50Q JK 981 797</u></p>

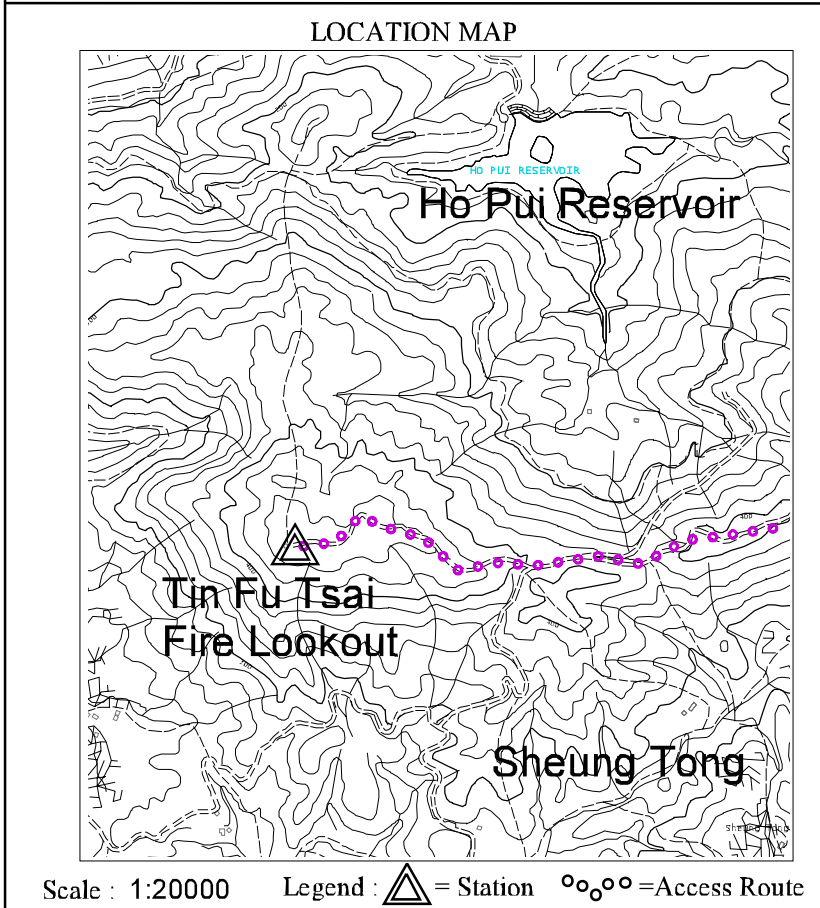
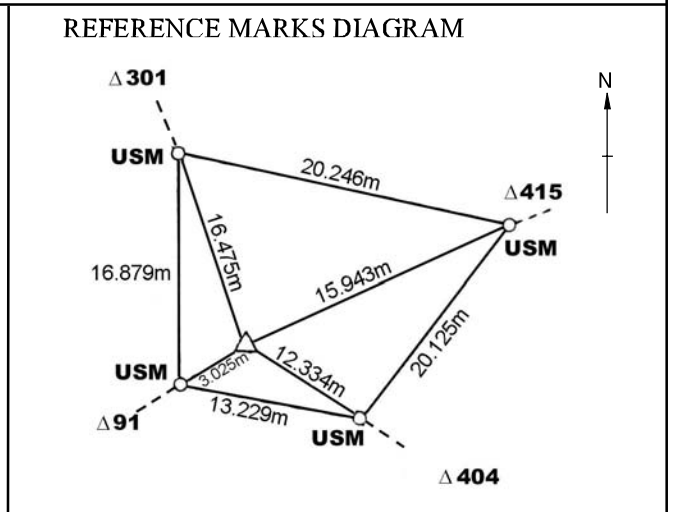
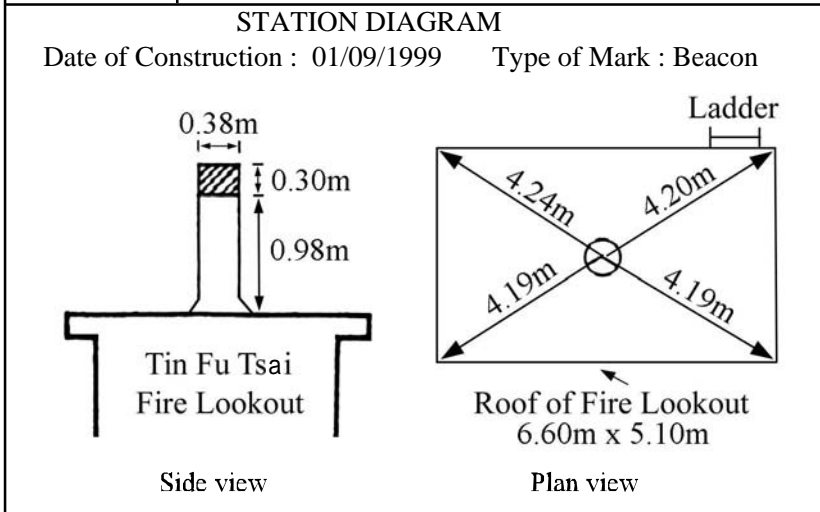

GRID BEARINGS TO ADJACENT TRIGS.	
415	40° 46' 17"
404	130° 31' 48"
91	231° 04' 56"
301	323° 29' 54"

**LAST MAINTENANCE RECORD :**

Last visit on : 22/09/2000

**REMARKS :**

- 1) The HK 1980 grid coordinates of this station are transformed from GPS surveyed geodetic coordinates.
- 2) Drive along Route Twisk to the Country Park Management Center. After obtaining permission, drive along the track to the Tin Fu Tsai Fire Lookout.