

TRIGONOMETRICAL STATION SUMMARY

STATION NO. : **506** (FORMER NO. : _____)

SURVEY SHEET NO. : **7-NW-24C**

TRIG. NAME : **GRASSY HILL**

LOCALITY : **SHING MUN COUNTRY PARK**

HK 80 DATUM	<p>HK 1980 GRID COORDINATES : N = 830 258.825 m, E = 835 135.797 m, Class : H2</p> <p>Ht = 648.1 m above HKPD and measured to the top of mark, Class : V6</p> <p>SCALE FACTOR : + 0.0 ppm to measured distance to give Grid Distance</p> <p>GRID CONVERGENCE : - 00' 20.8" to Grid Bearings to give Azimuth</p>
WGS 84 DATUM	<p>GEOGRAPHICAL COORDINATES : Lat = 22° 24' 41.92310" N, Long = 114° 9' 57.16009" E, Class : GH3</p> <p>Ht = 645.104 m above Ellipsoid and measured to the top of mark, Class : GV3</p> <p>Reference Frame = ITRF96</p> <p>UTM GRID COORDINATES : 2 481 144 mN, 208 226 mE</p> <p>UTM GRID REFERENCE : 50Q KK 082 811</p>

STATION PHOTO



REFERENCE MARKS DIAGRAM

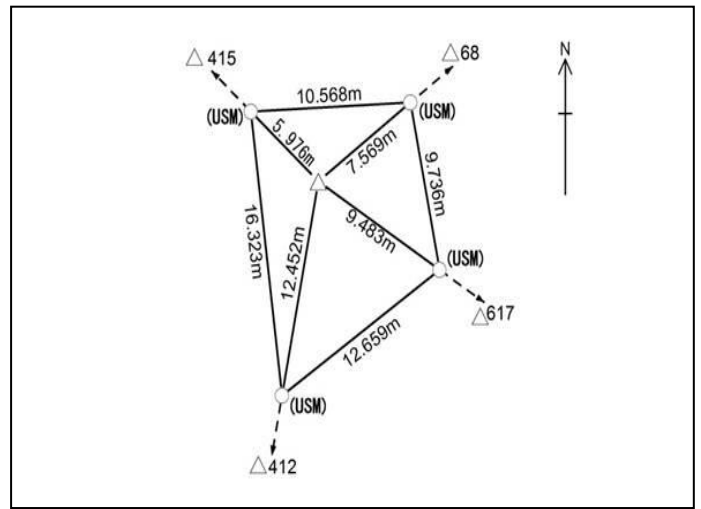

LOCATION MAP (Scale 1:50000)



GRID BEARINGS TO ADJACENT TRIGS.

526	20° 38' 30"
68	53° 36' 27"
505	96° 00' 51"
617	122° 10' 43"

REMARKS:

Date of Construction : 1976

Type of Mark :
Type A Beacon

- 1) Witness marks were installed in 2/95.
- 2) Ring-headed screws were installed in 7/02.