

TRIGONOMETRICAL STATION SUMMARY

STATION NO. : 523 (FORMER NO. : _____)

CLASS : _____

TRIG. NAME : LUK KENG

LOCALITY : LUK KENG

HK 80 DATUM	<p>HK 1980 GRID COORDINATES : N = <u>842 525.884</u> m , E = <u>840 054.617</u> m , Ht = <u>122.4</u> m (1)</p> <p style="font-size: small;">Note (1) : Height is above the HKPD and measured to the top of mark.</p> <p>LEVEL ACCURACY : _____</p> <p>SCALE FACTOR : + <u>0.1</u> ppm to measured distance to give Grid Distance</p> <p>GRID CONVERGENCE : <u>0 0' 45.0"</u> to Grid Bearings to give Azimuth</p>
WGS 84 DATUM	<p>GEOGRAPHICAL COORDINATES : Lat _____ N, Long _____ E, Ht= _____ m (2)</p> <p style="font-size: small;">Note (2) : Height is above the WGS 84 Ellipsoid and measured to the top of mark.</p> <p>GPS ACCURACY : _____</p> <p>REFERENCE FRAME : _____</p> <p>UTM GRID COORDINATES : <u>2 493 324</u> mN <u>213 379</u> mE</p> <p>UTM GRID REFERENCE : <u>50Q KK 134 933</u></p>

STATION DIAGRAM

Date of Construction : 01/01/1976 Type of Mark : Beacon

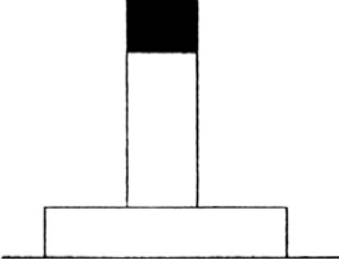

Side view



Plan view

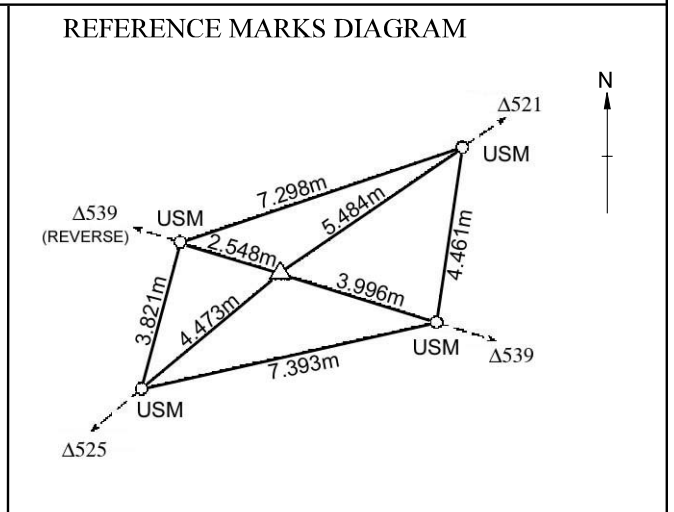

LOCATION MAP

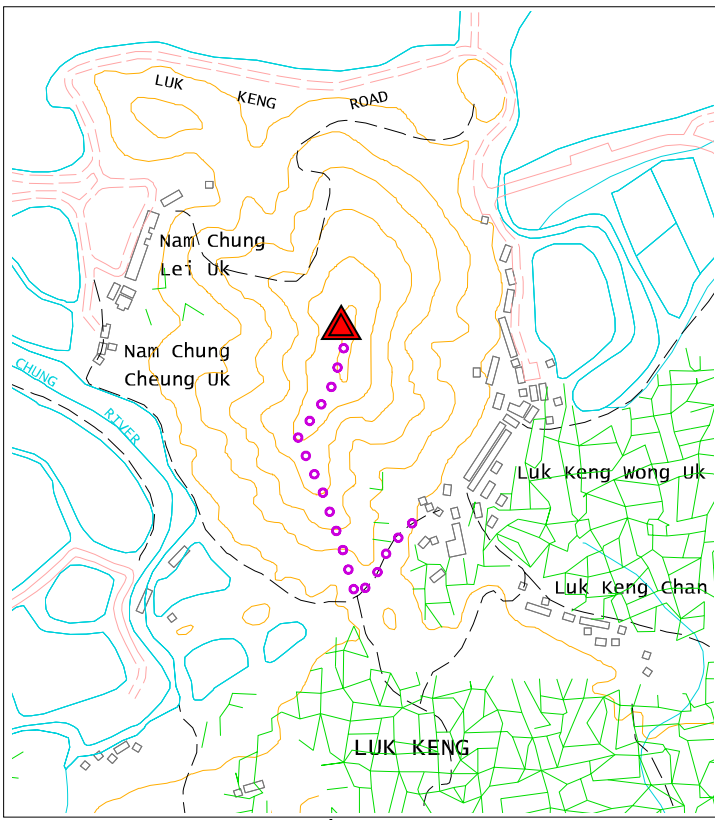

Scale : 1:10000 Legend : = Station = Access Route

GRID BEARINGS TO ADJACENT TRIGS.	
521	53° 36' 16"
519	104° 47' 44"
520	105° 23' 59"
534	105° 29' 49"

LAST MAINTENANCE RECORD :

Last visit on : 03/01/2003

REMARKS :

1) Fixing of witness marks on 2/87.