

# TRIGONOMETRICAL STATION SUMMARY

STATION NO. : 528 (FORMER NO. : \_\_\_\_\_)

CLASS : \_\_\_\_\_

TRIG. NAME : HONG LOK YUEN

LOCALITY : TAI PO

<b>HK 80 DATUM</b>	<b>HK 1980 GRID COORDINATES</b> : N = <u>836 314.841</u> m , E = <u>835 247.857</u> m , Ht = <u>289.7</u> m (1) <i>Note (1) : Height is above the HKPD and measured to the top of mark.</i> <b>LEVEL ACCURACY</b> : _____ <b>SCALE FACTOR</b> : + <u>0.0</u> ppm to measured distance to give Grid Distance <b>GRID CONVERGENCE</b> : <u>- 0' 19.3"</u> to Grid Bearings to give Azimuth
<b>WGS 84 DATUM</b>	<b>GEOGRAPHICAL COORDINATES</b> : Lat _____ N, Long _____ E, Ht= _____ m (2) <i>Note (2) : Height is above the WGS 84 Ellipsoid and measured to the top of mark.</i> <b>GPS ACCURACY</b> : _____ <b>UTM GRID COORDINATES</b> : <u>2 487 201</u> mN <u>208 453</u> mE <b>UTM GRID REFERENCE</b> : <u>50Q KK 085 872</u> <b>REFERENCE FRAME</b> : _____

**STATION DIAGRAM**

Date of Construction : 01/01/1981      Type of Mark : Beacon

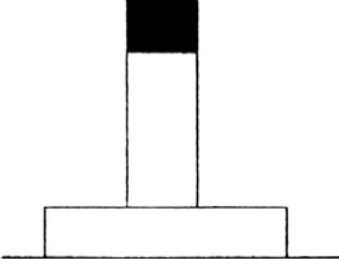

Side view

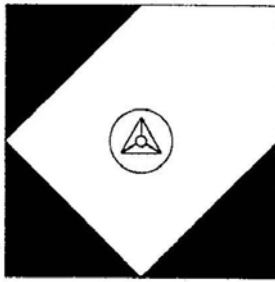

Plan view

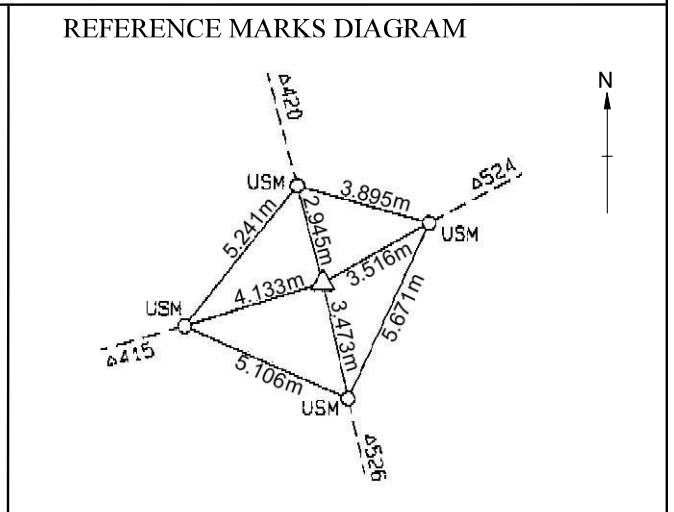

**LOCATION MAP**

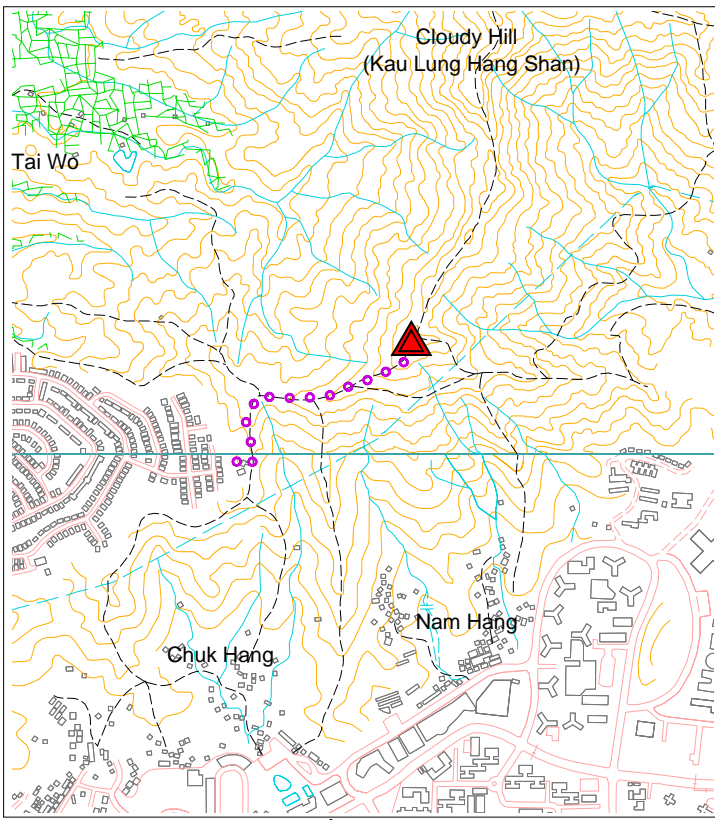

Scale : 1:20000      Legend : = Station      = Access Route

GRID BEARINGS TO ADJACENT TRIGS.	
66	19° 11' 14"
524	58° 58' 18"
532	106° 37' 37"
526	167° 24' 54"

**LAST MAINTENANCE RECORD :**  
Last visit on : 18/02/2003

**REMARKS :**

- 1) Walking from the cutting at Twenty-Seven Street about 45 minutes.
- 2) Fixing of witness marks on 10/97.