

TRIGONOMETRICAL STATION SUMMARY

STATION NO. : **621.1** (FORMER NO. : _____)

SURVEY SHEET NO. : **8-SW-1D**

TRIG. NAME : **WONG CHUK YEUNG FIRE LOOKOUT**

LOCALITY : **WONG CHUK YEUNG FIRE LOOKOUT**

HK 80 DATUM	<p>HK 1980 GRID COORDINATES : N = 828 955.919 m, E = 845 943.141 m, Class : H2</p> <p>Ht = 289.8 m above HKPD and measured to the top of mark, Class : V6</p> <p>SCALE FACTOR : + 1.1 ppm to measured distance to give Grid Distance</p> <p>GRID CONVERGENCE : + 02' 03.2" to Grid Bearings to give Azimuth</p>
WGS 84 DATUM	<p>GEOGRAPHICAL COORDINATES : Lat = _____ N, Long = _____ E, Class : _____</p> <p>Ht = _____ m above Ellipsoid and measured to the top of mark, Class : _____</p> <p>Reference Frame = _____</p> <p>UTM GRID COORDINATES : 2 479 637 mN, 219 013 mE</p> <p>UTM GRID REFERENCE : 50Q KK 190 796</p>

STATION PHOTO



REFERENCE MARKS DIAGRAM

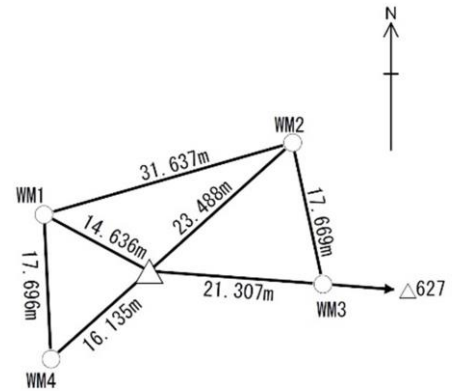

All witness marks are iron spikes in cement.

LOCATION MAP (Scale 1:20000)

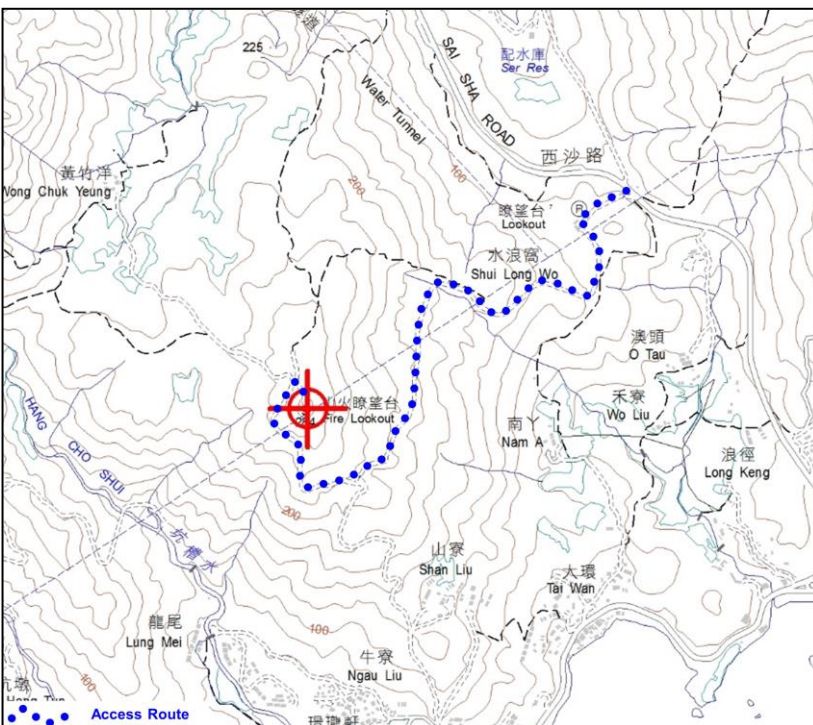

GRID BEARINGS TO ADJACENT TRIGS.

627	94° 19' 12"
619	140° 39' 25"

REMARKS:

Type of Mark :
Type A Beacon

Contact the Kei Ling Ha Country Park Management Centre at 2792 4578 before visit. A three-metre-long aluminium ladder and safety harness should be brought. Drive along Sai Sha Road to the management centre and borrow the key.

Drive along the road leading uphill to Wong Chuk Yeung. Stop in the vicinity of the fire lookout tower and walk about 3 mins. Unlock the gate of the fence and use the aluminium ladder and safety harness to climb up to the rooftop.