

# TRIGONOMETRICAL STATION SUMMARY

STATION NO. : **662** (FORMER NO. : \_\_\_\_\_)

SURVEY SHEET NO. : **11-NE-10C**

TRIG. NAME : **RAZOR HILL**

LOCALITY : **PIK UK AU**

<b>HK 80 DATUM</b>	<p><b>HK 1980 GRID COORDINATES :</b> N = <b>822 173.756</b> m, E = <b>844 038.065</b> m, Class : <b>N.A.</b></p> <p>Transformed from WGS84 (ITRF96) Ht = <b>433.1</b> m above HKPD and measured to the top of mark, Class : <b>V5</b></p> <p>SCALE FACTOR : <b>+ 0.7</b> ppm to measured distance to give Grid Distance</p> <p>GRID CONVERGENCE : <b>+ 01' 37.5"</b> to Grid Bearings to give Azimuth</p>
<b>WGS 84 DATUM</b>	<p><b>GEOGRAPHICAL COORDINATES :</b> Lat = <b>22° 20' 19.01598"</b> N, Long = <b>114° 15' 8.28186"</b> E, Class : <b>GH3</b></p> <p>Ht = <b>430.680</b> m above Ellipsoid and measured to the top of mark, Class : <b>GV3</b></p> <p>Reference Frame = <b>ITRF96</b></p> <p><b>UTM GRID COORDINATES :</b> <b>2 472 888</b> mN, <b>216 980</b> mE</p> <p><b>UTM GRID REFERENCE :</b> <b>50Q KK 169 728</b></p>

STATION PHOTO

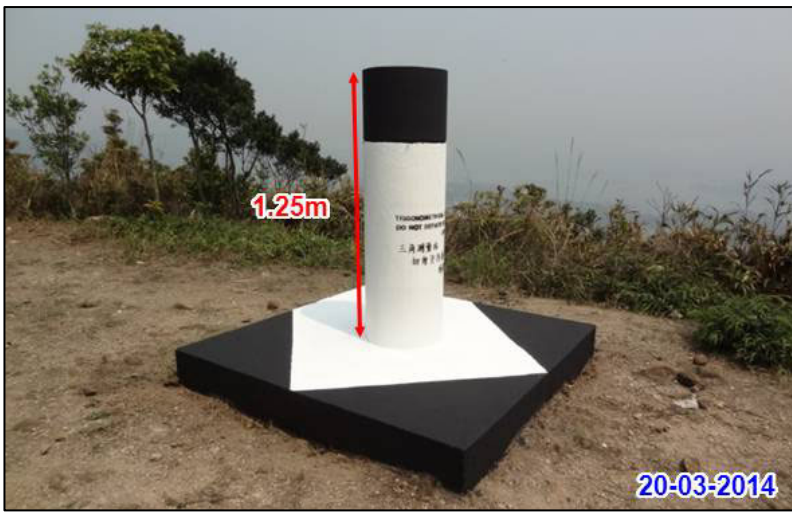

REFERENCE MARKS DIAGRAM

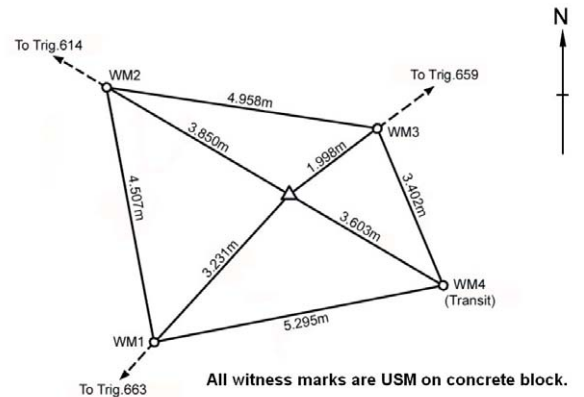

LOCATION MAP (Scale 1:5000)

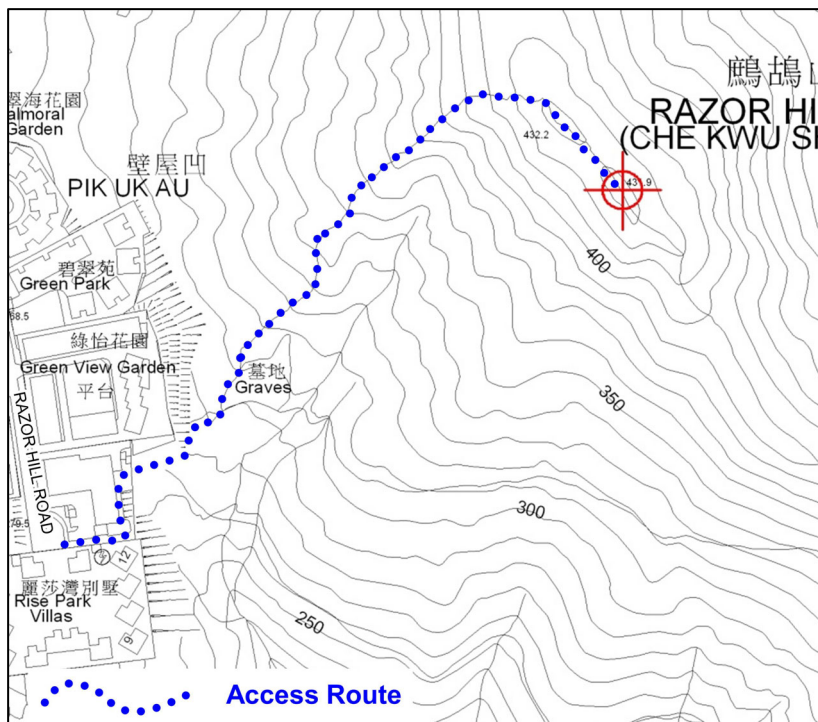

GRID BEARINGS TO ADJACENT TRIGS.

<b>659</b>	<b>53° 02' 37"</b>
<b>606</b>	<b>143° 52' 31"</b>
<b>663</b>	<b>222° 24' 35"</b>
<b>137</b>	<b>274° 42' 07"</b>

**REMARKS:**

Date of Construction : Apr 2003

Type of Mark :  
Type A Beacon

Take about 30 minutes to walk uphill from Razor Hill Road.