

TRIGONOMETRICAL STATION SUMMARY

STATION NO. : **84** (FORMER NO. : _____)

SURVEY SHEET NO. : **13-SE-11B**

TRIG. NAME : **FEI KEI TENG**

LOCALITY : **FEI KEI TENG, TAI A CHAU**

HK 80 DATUM	<p>HK 1980 GRID COORDINATES : N = 803 271.200 m, E = 808 910.428 m, Class : H1</p> <p>Ht = 86.9 m above HKPD and measured to the top of mark, Class : V6</p> <p>SCALE FACTOR : + 9.5 ppm to measured distance to give Grid Distance</p> <p>GRID CONVERGENCE : - 06' 05.9" to Grid Bearings to give Azimuth</p>
WGS 84 DATUM	<p>GEOGRAPHICAL COORDINATES : Lat = 22° 10' 3.77256" N, Long = 113° 54' 41.86373" E, Class : GH3</p> <p>Ht = 83.336 m above Ellipsoid and measured to the top of mark, Class : GV3</p> <p>Reference Frame = ITRF96</p> <p>UTM GRID COORDINATES : 2 454 271 mN, 800 279 mE</p> <p>UTM GRID REFERENCE : 49Q HE 002 542</p>

STATION PHOTO



REFERENCE MARKS DIAGRAM

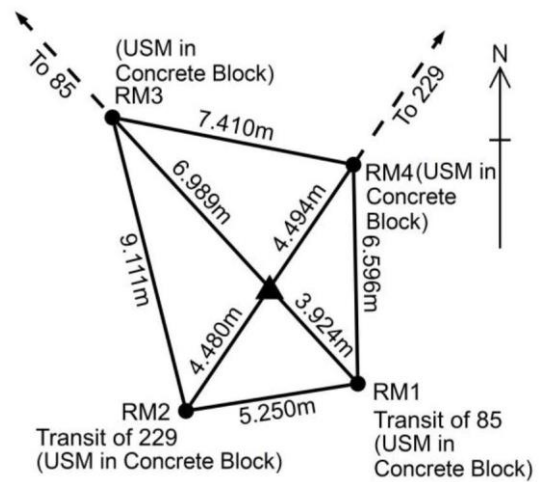

LOCATION MAP (Scale 1:5000)



GRID BEARINGS TO ADJACENT TRIGS.

85	317° 17' 21"
223	336° 21' 32"
228	01° 14' 50"
87	05° 35' 33"

REMARKS:

Type of Mark :
Type A Beacon