

TRIGONOMETRICAL STATION SUMMARY

STATION NO. : 94 (FORMER NO. : _____)

CLASS : _____

TRIG. NAME : AU TAU

LOCALITY : AU TAU

HK 80 DATUM	<p>HK 1980 GRID COORDINATES : N = <u>833 430.784</u> m , E = <u>823 008.109</u> m , Ht = <u>150.64</u> m (1)</p> <p style="font-size: small;">Note (1) : Height is above the HKPD and measured to the top of mark.</p> <p>LEVEL ACCURACY : _____</p> <p>SCALE FACTOR : + <u>2.3</u> ppm to measured distance to give Grid Distance</p> <p>GRID CONVERGENCE : <u>-03' 02.7"</u> to Grid Bearings to give Azimuth</p>
WGS 84 DATUM	<p>GEOGRAPHICAL COORDINATES : Lat <u>22° 26' 24.85837"</u>N, Long <u>114° 2' 53.02745"</u> E, Ht= <u>147.052</u>m (2)</p> <p style="font-size: small;">Note (2) : Height is above the WGS 84 Ellipsoid and measured to the top of mark.</p> <p>GPS ACCURACY : _____</p> <p>REFERENCE FRAME : ITRF96</p> <p>UTM GRID COORDINATES : <u>2 484 546</u> mN <u>196 152</u> mE</p> <p>UTM GRID REFERENCE : <u>50Q JK 962 845</u></p>

STATION DIAGRAM

Date of Construction : 01/01/1976 Type of Mark : Beacon

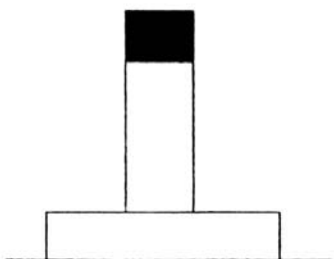

Side view



Plan view

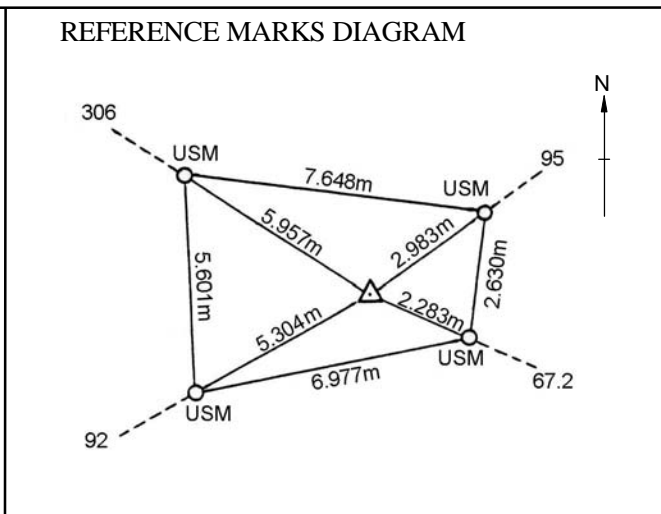

LOCATION MAP

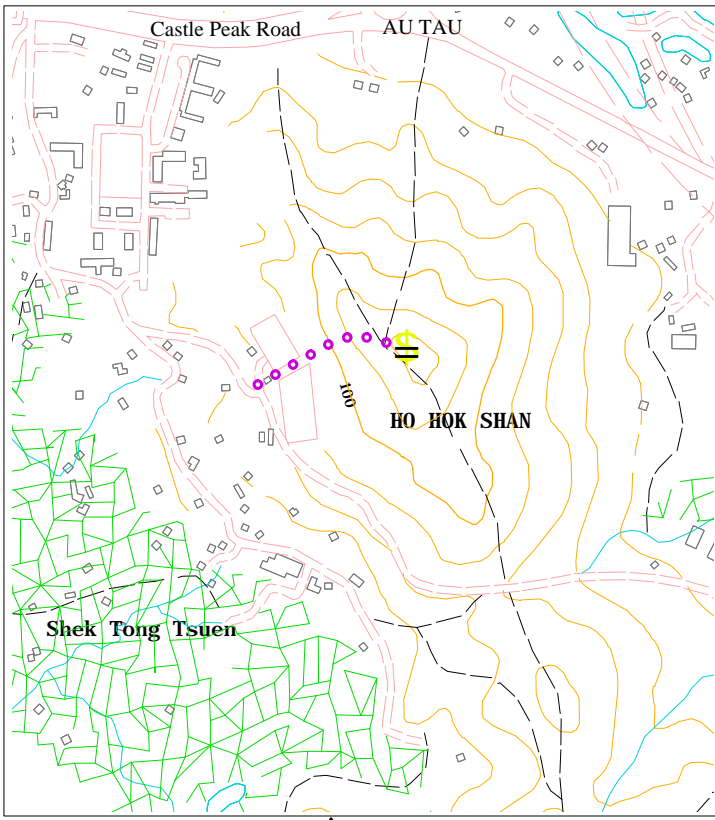

Scale : 1:10000 Legend : = Station = Access Route

GRID BEARINGS TO ADJACENT TRIGS.

305	16° 45' 59"
304	35° 20' 36"
95	54° 51' 40"
303	74° 51' 02"

LAST MAINTENANCE RECORD :

Last visit on : 28/08/2002

REMARKS :

1) Witness marks were installed in 9/90.